

51 47

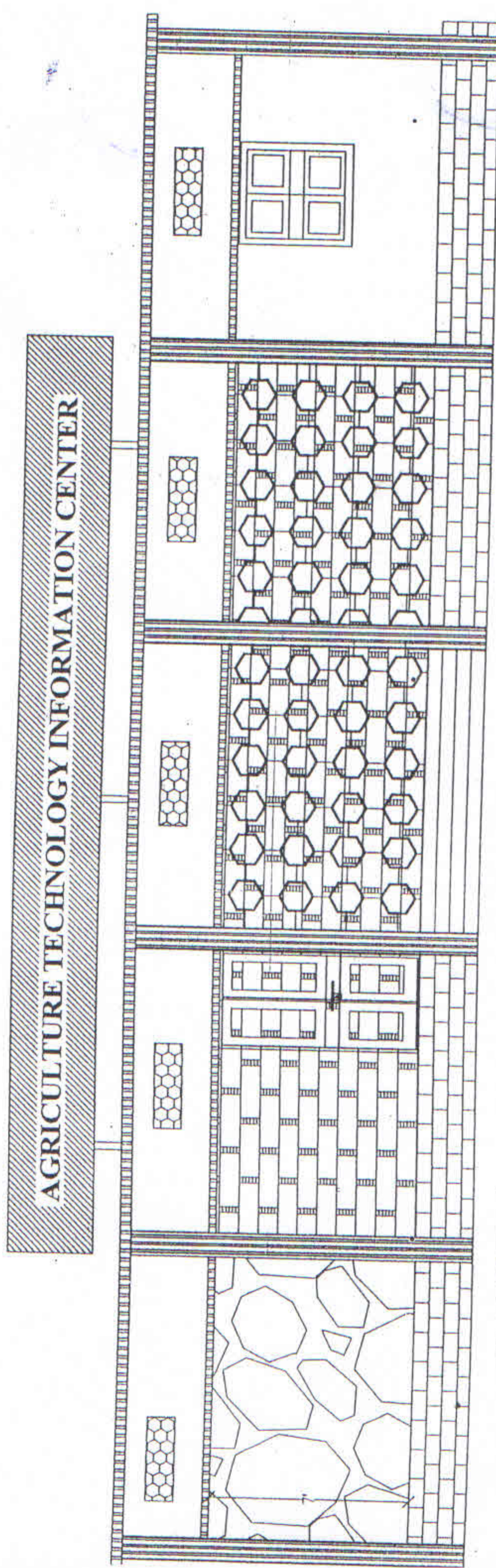

AGRICULTURE TECHNOLOGY INFORMATION CENTER

FRONT ELEVATION

50 46

COST ESTIMATE FOR CONSTRUCTION OF AGRICULTURE TECHNOLOGY INFORMATION CENTER AT JHARKHAND

REPORT

An estimate amounting Rs- 15, 00,000.00 (Fifteen Lakhs) only has been framed to meet the expenses of construction of a Agriculture Technology information center in the state of Jharkhand.

The total land area is required for the construction of Agriculture Technology information center is - 3700.00sft or 334.10 sq m (Plot area = 100'-0" x 37'-0" = 3700.00sft)

The Project comprises of following components:-

- i) Construction of Agriculture Technology information center
- ii) Construction of Septic tank, soakage pit & Toilet.
- iii) Provision of deep tube well with submersible motor
- iv) Estimate includes sanitary and water supply system.
- v) Provision of electricity fitting with/Panel board.
- vi) Construction of Generator Room.

The plinth level of building has been kept 2'-00" from the existing ground level and ceiling height of 10'-0" for ground floor. The reinforced cement concrete has been considered as M-150 (1:2:4) for structural members. Aluminum door & windows provided in room and PVC door in bathroom. The ventilator, Hall & Verandah have been provided with standard steel section fully glazed grill. The flooring has been provided Kotah stone flooring in room, verandah and stair. The inside and outer wall surface is covered with two of snowcem as per approved shade. The estimate has been framed on the basis of schedule of rate of south chhotanagpur division effective from 2010. The rate which is not available in C.P.W.D. prevalent Current market rate has been taken.

Assistant Engineer

Soil Conservation, Ranchi

Dy. Director (Engg)

Directorate, Jharkhand

49 48

GENERAL ABSTRACT

Name Of Work: - Construction of Agriculture Technology Information Center

(Based on Schedule of rate of South Chotanagpur Division w.e.f. February-2010 and D.S.R -2007)

SL.NO	PARTICULARS	AMOUNT
1	Civil Work	Rs- 8,45,300.00 ✓
2	Generator Room	Rs-91,100.00 ✓
3	Septic Tank & Toilet	Rs- 69,500.00 ✓
5	Water Supply & Sanitary	Rs- 51,900.00 ✓
4	Electrical Work	Rs- 65,600.00 ✓
6	Deep Boring	Rs- 1,33,800.00 ✓
	TOTAL	Rs- 12,57,200.00 ✓
	Computer/ furniture/ Generator Etc.	Rs- 2,42,800.00 ✓
	TOTAL	Rs- 15,00,000.00 ✓
	Grand Total Say	Rs- 15,00,000.00 ✓

Rs- 15, 00,000/- (FIFTEEN LAKHS) ONLY

[Signature]
Assistant Engineer
 Soil Conservation, Ranchi

[Signature]
Dy. Director (Engg)
 Directorate, Jharkhand

Technically Sanctioned amounting Rs 15.00 lacs (Rupees -fifteen lacs) only accorded.

[Signature]
Manager Technical
Jhalco, Ranchi

[Signature]
Managing Director,
Jharkhand Hill Area
Lift Irrigation Corporation, Ranchi

PROPOSED PLAN OF AGRICULTURE TECHNOLOGY INFORMATION CENTER, JHARKHAND

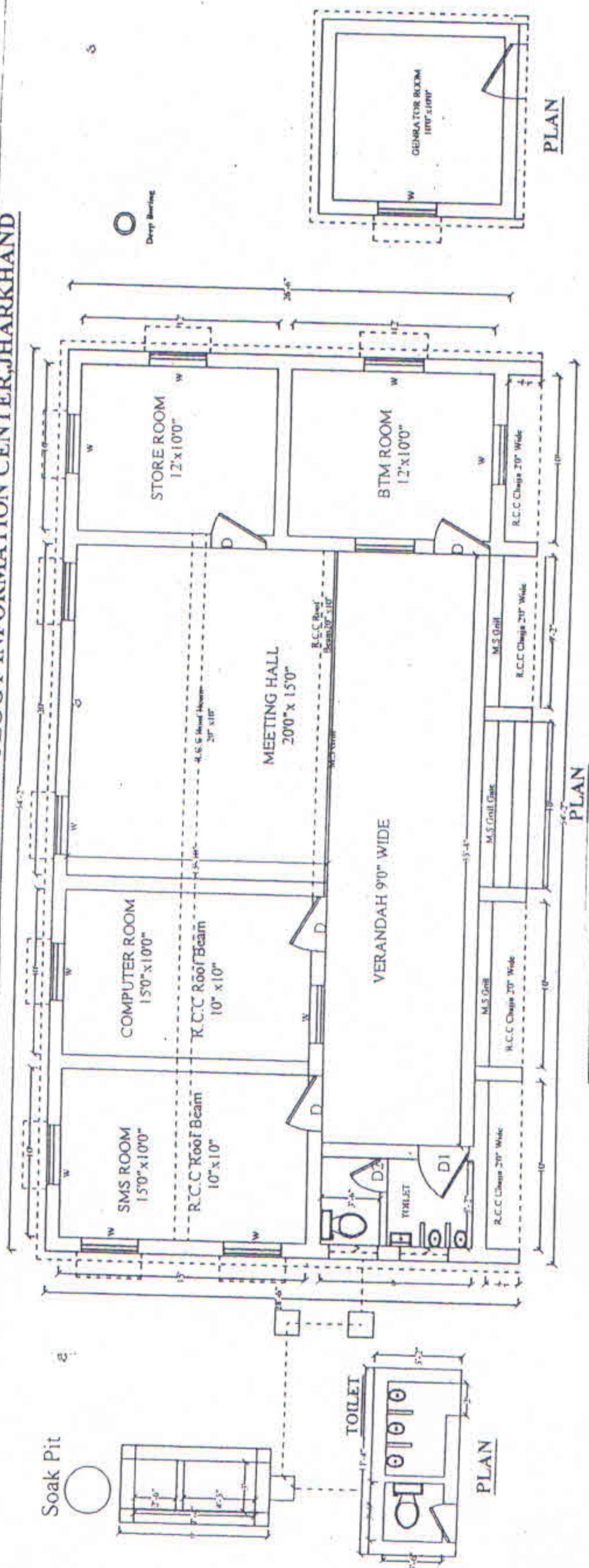

AGRICULTURE TECHNOLOGY INFORMATION CENTER

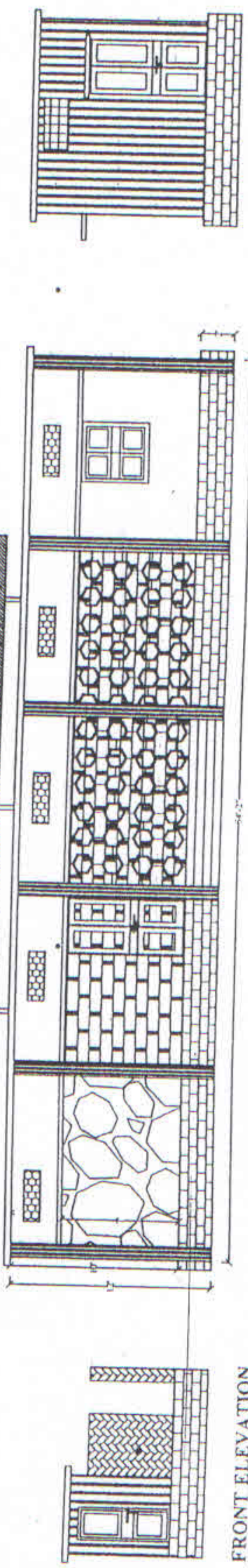

FRONT ELEVATION

FRONT ELEVATION

OPENING SCHEDULE

1	10' x 30' x 60"
2	12' x 30' x 15"
3	12' x 30' x 15"
4	10' x 30' x 15"
5	10' x 30' x 15"

Prepared By: *[Signature]*
 Rakesh Kumar Choudhary
 Assistant Engineer,
 Soil Conservation Ranchi, Jharkhand

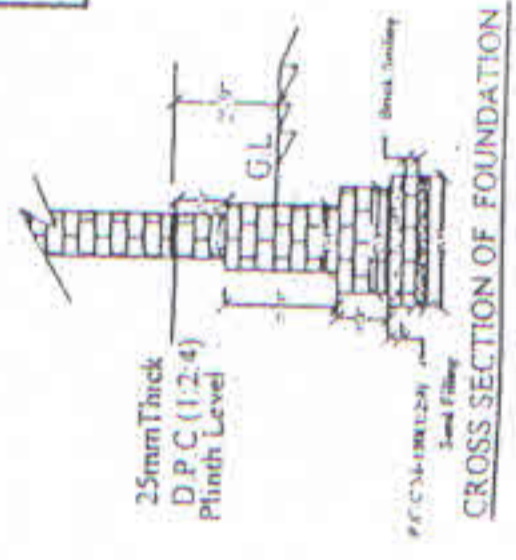

CROSS SECTION OF FOUNDATION

KEY PLAN OF AGRICULTURE TECHNOLOGY INFORMATION CENTER, JHARKHAND

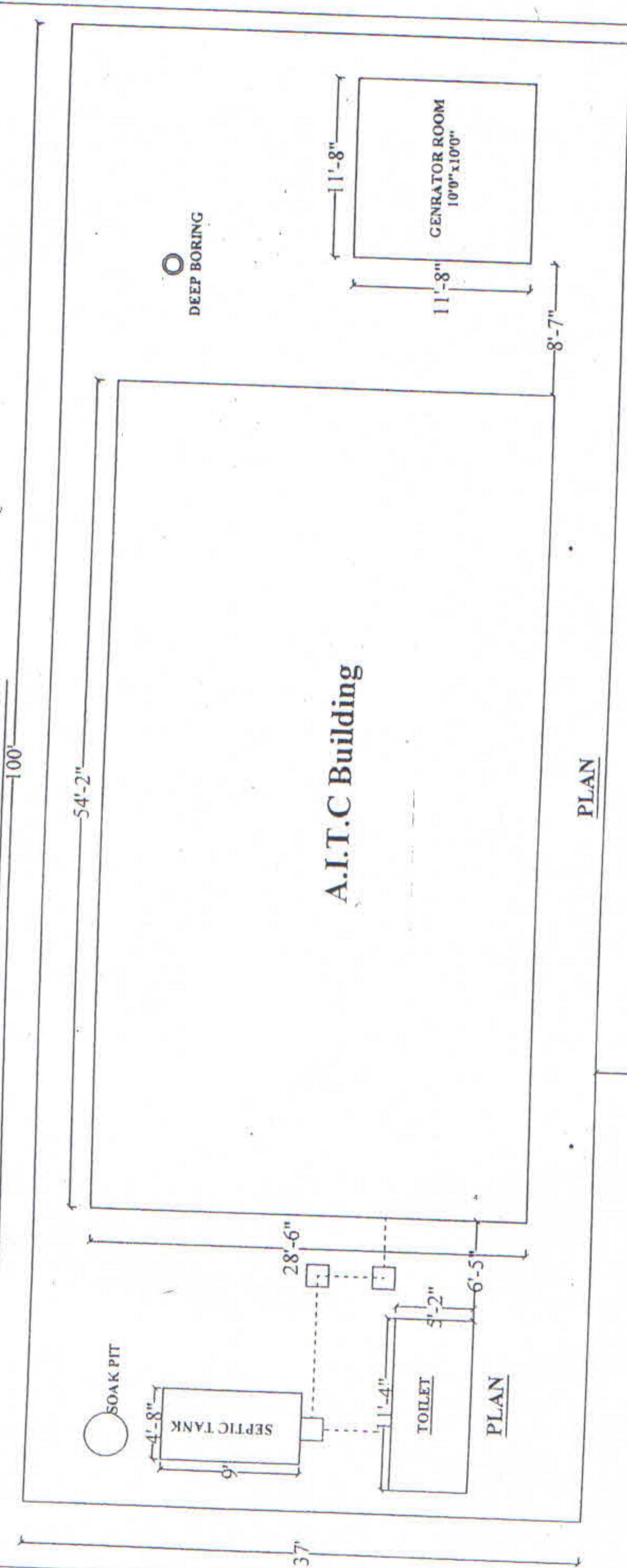

PLAN

Main Road 15' wide

Prepared By 
Rakesh Kumar Choudhary
Assistant Engineer,
Soil Conservation Ranchi,
Jharkhand

46 42

L

(A)

**ABSTRACT OF COST FOR THE WORK CONSTRUCTION OF AGRICULTURE TECHNOLOGY
INFORMATION CENTER, JHARKHAND**

S.NO	PARTICULARS	QUANTITY	UNIT	RATE	AMOUNT
1/5.1.1	E/W in excavation in foundation trenches in ordinary soil (vide classification of soil item -A) and disposal of excavated earth as obtained to a distance up to 50 M---do-- all complete as per approved design, building specification and direction of E/I.	51.505	m ³	48.07	2475.83
2/5.1.10	Providing coarse clean sand in filling in foundation trenches or in plinth including ramming and watering in layers not exceeding 150mm---do-- all complete as per building specification and direction of E/I.	59.025	m ³	115.76	6832.75
3/5.6.1	Providing designation 75A one brick flat soling joints filled with local sand including cost of watering taxes royalty all complete as building specification and direction of E/I.	208.075	m ²	122.92	25576.63
4/5.3.2	Providing P.C.C M-100 in nominal mix of (1:2:4) in foundation with approved quality of stone chips 20mm to 6mm size graded and clean coarse sand of F.M 2.5mm to 3mm -do-- all complete as per building specification and direction of E/I.	10.402	m ³	3493.58	36341.62
5/5.2.3	Providing designation 75A Brick work in C.M (1:6) in foundation with approved quality of clean coarse sand of F.M. 2. to 2.5 -do-- all complete as per building specification and direction of E/I	40.030	m ³	2164.22	86633.68
6/5.3.16	Providing 25mm thick damp proof course with cement concrete M-150 with nominal mix of (1:2:4) with approved quality of stone chips 20mm to 6mm size graded and clean coarse sand of F.M 2.5mm to 3mm -do--taxes and royalty all complete as per building specification and direction of E/I.	19.503	m ²	106.02	2067.69
7/5.2.11	Providing designation 75A Brick work in C.M (1:6) in Super structure with approved quality of clean coarse sand of F.M. 2 to 2.5 -do-- all complete as per building specification and direction of E/I	47.030	m ³	2208.50	103866.06
8/5.3.8	Providing R.C.C M-150 in nominal mix of (1:2:4) in Lintel with approved quality of stone chips 20mm to 6mm size graded and clean coarse sand of F.M 2.5mm to 3mm -do--taxes and royalty all complete as per building specification and direction of E/I.	3.930	m ³	4412.45	17340.00
9/5.3.15	Providing Av 63mm R.C.C M-150 in nominal mix of (1:2:4) in chajja with approved quality of stone chips 20mm to 6mm size graded and clean coarse sand of F.M 2.5mm to -do- all complete as per building specification and direction of E/I.	14.470	m ²	525.39	7602.32
10/5.3.11	Providing R.C.C M-150 in nominal mix of (1:2:4) in beam of all type level with approved quality of stone chips 20mm to 6mm size graded and clean coarse sand of F.M 2.5mm to 3mm -do--taxes and royalty all complete as per building specification and direction of E/I.	1.965	m ³	5338.87	10490.73
11/5.3.9	Providing R.C.C M-150 in nominal mix of (1:2:4) in roof slab level with approved quality of stone chips 20mm to 6mm size graded and clean coarse sand of F.M 2.5mm to 3mm -do--taxes and royalty all complete as per building specification and direction of E/I.	16.979	m ³	4467.93	75862.13
12/5.7.3	Providing 12mm. cement plaster (1:6) with clean coarse sand of F.M.1.5. including screening, curing with all leads and lifts of water, scaffolding taxes and royalty all complete as per drawing specification and direction of E/I.	473.920	m ²	60.88	28852.23
13/5.7.6	Providing 6mm.thick cement plaster (1:4) in ceiling with clean coarse sand of F.M.1.5. including screening, curing with all leads and lifts of water, scaffolding taxes and royalty all complete as per drawing specification and direction of E/I.	113.839	m ²	60.57	6895.20

45 41

14/5.6.19(i)	Providing and laying 15-20 mm thick kotah stone slab flooring of approved quality over 19mm cement mortar (1:3) and joints filled with gray cement slurry, flush pointed with white cement – do- taxes and royalty all complete as per building specification and direction of E/I.	119.260	m ²	795.00	94812.03
15/5.7.11	Providing 1.5mm thick cement punning including curing etc. complete job as per specification and direction of E/I.	37.121	m ²	23.63	877.17
16/5.6.23.4	Providing and laying 6mm precast white glazed tiles in wall over 12mm cement mortar (1:3) and joints filled with gray cement slurry, flush pointed with white cement –do- ,taxes and royalty all complete as per building specification and direction of E/I.	15.661	m ²	599.96	9396.09
17/5.8.24	Providing two coat of snowcem of approved shade and make over a coat of cement primer on new surface including preparing the plastered surface smooth with sand paper, scaffolding, curing and taxes all complete as per building specification and direction of E/I.	587.758	m ²	40.94	24062.82
18/5.5.29	Providing and fixing glazing in Aluminum door, window, ventilator shutter and partition etc. with PVC/ neoprene gasket etc. complete as per the architectural drawing and the direction of E/I.	22.506	m ²	2050.00	46137.30
19/80020 D.S.R	30mm thick Factory made shutter with frame, rail and panels of PVC extruded sections in white, grey or wooden finish	3.255	m ²	1900.00	6184.50
20/5.5.18	Supplying, fitting, and fixing fully glazed steel doors & windows or ventilator of standard rolled 'Z' and mullion –do- in P.C.C. (1:2:4) blocks-do- a priming red lead paint over steel work, taxes all complete as per drawing specification and direction of E/I.	0.837	m ²	1719.55	1439.26
21/5.5.12	Supplying, fitting, and fixing M.S. grill made of 20x6mm M.S. flats as per approved design and drawing, properly fabricated, with joints continuous fillet welded and finished smooth, carriage of grill to site, hoisting as per specification and direction of E/I.	1036.380	Kg	48.24	49994.97
22/5.5.13	Providing and fixing fan hook with –do- , all complete, as per specification & direction of E/I	12.000	Each	72.27	867.24
23/5.8.41 ⁴ 5.8.43	Providing two coats of ready mixed paint of approved shade and make over steel surface including cleaning the surface thoroughly scaffolding, taxes all complete as per building specification and direction of E/I.	78.446	m ²	55.81	4378.06
24/5.5.4	Providing Tor steel reinforcement above 8mm dia rods as per approved design and drawing excluding carriage of M S. Rods(straight or in coil) to work site, cutting, bending, and binding with annealed wire with cost of wire ,removal of rust, placing the rods in position all complete as per building specification and direction of E/I.	2.118	MT	43724.78	92605.45

Q2

44 40

25/5.10.34	Providing 150mm. wide brick drain in cement mortar(1:6) with av. 150mm. clear depth and 125mm apron including cost of earth work involved with 75mm cement concrete (1:4:3) over one brick designation 75 A, flat soling in proper grade and slope at the base the drain duty plastered in C.M.(1:3) with punning over exposed surface all complete as per building specification and direction of E/I.	48.664	M	290.53	14138.46
TOTAL-					755730.21
26/ Chap -III	<u>CARRIAGE OF MATERIAL</u>				
	ITEMS	QUANTITY	KM	RATE	
	Sand	167.00 m ³	10	162.78	27184.06
	Cement	40.20 m.t	10	101.74	4090.31
	Chips	90.29 m ³	30	295.98	26725.23
	Bricks	63393.50 nos	15	495.44	31407.67
	Steel	2.12 mt	10	101.74	215.48
TOTAL-					845352.96

Say Rs- 8, 45,300/-

Rs-8, 45,300/-(EIGHT LAKHS FORTY FIVE THOUSAND THREE HUNDRED) ONLY

Assistant Engineer
 Soil Conservation, Ranchi

Dy. Director (Engg)
 Directorate, Jharkhand

MATERIAL STATEMENT

ITEM NO.	WORKS	QUANTITY	SAND	CEMENT	CHIPS	BRICKS
5.1.10	Sand Filling	59.025115	59.03			
5.2.3	Brick Work (1:6) in foundation	40.030	13.73	2.281709		16254.973
5.2.14	Brick Work (1:6) in Superstructure	47.030	16.13	2.680718		19097.528
5.3.2	PCC (1:2:4)	10.4024	4.68	2.34054	9.3622	
5.3.8	Lintel	3.930	1.77	0.884203	3.5368	
5.3.9	Roof Slab	16.9793	7.64	3.820333	15.281	
5.3.10	Beam	1.9650	0.88	0.442119	1.7685	
5.3.15	Chajja	14.470	6.51	3.255721	13.023	
5.3.16	DPC	19.503	0.30	0.148221	0.6046	
5.6.1	Brick flat Soling	208.07541	3.12			6710.432
5.7.3	Plaster (1:6)	473.920	7.58	1.232191		
5.7.6 ₉	Ceiling Plaster (1:4)	113.839	0.80	0.227677		
5.7.11	Punning 1.5mm	37.121		0.074242		
5.10.34	Drain 150mm wide (flat soiling)	48.664	0.73			1569.426
	P.C.C(1:4:8)	48.664	23.36	5.839724	46.718	
	Brick work CM(1:6)	48.664	16.69	2.773869		19761.140
	Plaster(1:6)	48.664	0.78	0.126527		
	Punning 1.5mm	48.664		0.097329		
5.6.19	Kotah Stone	119.260	3.27	0.57722		
	Total-		167.00m ³	26.80234m ³	90.294m ³	63393.498nos
				40.20351mt		

CARRIAGE OF MATERIAL

ITEMS	QUANTITY	KM
Sand	167.00 m ³	10
Cement	40.20 m.t	10
Chips	90.29 m ³	30
Bricks	63393.50 nos	15
Steel	2.12 mt	10

(Signature)
Assistant Engineer

Soil Conservation, Ranchi

(Signature)
Dy. Director (Engg)

Directorate, Jharkhand

**DETAIL ESTIMATE FOR THE WORK CONSTRUCTION OF AGRICULTURE TECHNOLOGY
INFORMATION CENTER, JHARKHAND**

S.NO	PARTICULARS	NOS	L	B	H	QUANTITY	
1/5.1.1	E\W in excavation in foundation trenches in ordinary soil (vide classification of soil item -A) and disposal of excavated earth as obtained to a distance up to 50 M---do-- all complete as per approved design, building specification and direction of E/I.						
		2	55.83	2.5	3	837.450	
		3	23.17	2.5	3	521.325	
		1	19.17	2.5	3	143.775	
		1	8.33	2.5	3	62.475	
		1	13.33	2.5	3	99.975	
		1	13.33	2.5	3	99.975	
		1	7.33	2.5	3	54.975	
		total				1819.950	51.505 m ³
2/5.1.10	Providing coarse clean sand in filling in foundation trenches or in plinth including ramming and watering in layers not exceeding 150mm---do-- all complete as per building specification and direction of E/I .						
		2	55.83	2.5	0.25	69.788	
		3	23.17	2.5	0.25	43.444	
		1	19.17	2.5	0.25	11.981	
		1	8.33	2.5	0.25	5.206	
		1	13.33	2.5	0.25	8.331	
		1	13.33	2.5	0.25	8.331	
		1	7.33	2.5	0.25	4.581	
		2	12.00	10	1.58	379.200	
		1	20.00	15.83	1.58	500.228	
		2	15.00	10	1.58	474.000	
		1	9.00	5.17	1.58	73.517	
		1	35.66	9	1.58	507.085	
		total				2085.693	59.025 m ³
3/5.6.1	Providing designation 75A one brick flat soling joints filled with local sand including cost of watering taxes royalty all complete as building specification and direction of E/I.						
		2	55.83	2.5		279.150	
		3	23.17	2.5		173.775	
		1	19.17	2.5		47.925	
		1	8.33	2.5		20.825	
		1	13.33	2.5		33.325	
		1	16.33	2.5		40.825	
		1	7.33	2.5		18.325	
		2	12.00	10		240.000	
		1	20.00	15.83		316.600	
		2	15.00	10		300.000	
		1	9.00	5.17		46.530	
		1	35.66	9		320.940	
	Plinth protection	1	159.66	2.5		399.150	
		total				2237.370	208.075 m ³

✓

4/5.3.2	Providing P.C.C M-100 in nominal mix of (1:2:4) in foundation with approved quality of stone chips 20mm to 6mm size graded and clean coarse sand of F.M 2.5mm to 3mm -do- - all complete as per building specification and direction of E/I.								
		2	55.83	2.5	0.25	69.788			
		3	23.17	2.5	0.25	43.444			
		1	19.17	2.5	0.25	11.981			
		1	8.33	2.5	0.25	5.206			
		1	13.33	2.5	0.25	8.331			
		1	16.33	2.5	0.25	10.206			
		1	7.33	2.5	0.25	4.581			
		2	12.00	10	0.17	40.800			
		1	15.83	20	0.17	53.822			
		2	15.00	10	0.17	51.000			
		1	35.66	9	0.17	54.560			
		1	5.17	9	0.17	7.910			
		3	11.66	1	0.17	5.947			
						367.576	10.402	m ³	
5/5.2.3	Providing designation 75A Brick work in C.M (1:6) in foundation with approved quality of clean coarse sand of F.M. 2 to 2.5 -do-- all complete as per building specification and direction of E/I								
	1st footing	2	55.33	2	1	221.320			
		3	23.66	2	1	141.960			
		1	19.66	2	1	39.320			
		1	8.83	2	1	17.660			
		1	13.83	2	1	27.660			
		1	13.83	2	1	27.660			
		1	7.83	2	1	15.660			
	2nd Footing	2	54.58	1.25	2.17	296.097			
		3	24.42	1.25	2.17	198.718			
		1	20.42	1.25	2.17	55.389			
		1	9.58	1.25	2.17	25.986			
		1	14.58	1.25	2.17	39.548			
		1	14.58	1.25	2.17	39.548			
		1	8.58	1.25	2.17	23.273			
	3rd footing	2	54.17	0.83	1	89.922			
		3	24.83	0.83	1	61.827			
		1	20.83	0.83	1	17.289			
		1	10.00	0.83	1	8.300			
		1	15.00	0.83	1	12.450			
		1	15.00	0.83	1	12.450			
		1	9.00	0.83	1	7.470			
	Step	1	11.66	3	0.5	17.490			
		1	11.66	2	0.5	11.660			
		1	11.66	1	0.5	5.830			
						1414.487	40.030	m ³	
6/5.3.16	Providing 25mm thick damp proof course with cement concrete M-150 with nominal mix of (1:2:4) with approved quality of stone chips 20mm to 6mm size graded and clean coarse sand of F.M 2.5mm to 3mm -do--taxes and royalty all complete as per building specification and direction of E/I.								
		2	54.17	0.83		89.922			
		3	24.83	0.83		61.827			
		1	20.83	0.83		17.289			
		1	10.00	0.83		8.300			
		1	15.00	0.83		12.450			
		1	15.00	0.83		12.450			

40 86

		1	9.00	0.83	7.470			
				total-	209.708	19.503	m ²	
7/5.2.11	Providing designation 75A Brick work in C.M (1:6) in Super structure with approved quality of clean coarse sand of F.M. 2 to 2.5 -do-- all complete as per building specification and direction of E/I							
		2	54.17	0.83	10	899.222		
		3	24.83	0.83	10	618.267		
		1	20.83	0.83	10	172.889		
		1	10.00	0.83	10	83.000		
		1	15.00	0.83	10	124.500		
		1	15.83	0.83	10	131.389		
		1	9.00	0.83	10	74.700		
		1	5.17	0.42	7	15.200		
		6	2.00	0.83	12	119.520		
				Total-		2238.687		
	Less- Door	4	3.50	0.83	7	81.340		
		1	3.00	0.83	7	17.430		
		1	2.00	0.83	7	11.620		
	Window	12	3.00	0.83	4	119.520		
	Verandah Grill	1	9.17	0.83	7	53.278		
		2	10.00	0.83	7	116.200		
	Lintal	1	253.49	0.83	0.66	138.862		
	Ventilator	10	1.50	0.83	1	12.450		
	Toilet grill	2	3.00	0.83	1.5	7.470		
		5	3.00	0.83	1.5	18.675		
				Total-		576.845		
				Total-		1661.842	47.030	m ³
8/5.3.8	Providing R.C.C M-150 in nominal mix of (1:2:4) in Lintal with approved quality of stone chips 20mm to 6mm size graded and clean coarse sand of F.M 2.5mm to 3mm -do--taxes and royalty all complete as per building specification and direction of E/I.							
		2	54.17	0.83	0.66	59.349		
		3	24.83	0.83	0.66	40.806		
		1	20.83	0.83	0.66	11.411		
		1	10.00	0.83	0.66	5.478		
		1	15.00	0.83	0.66	8.217		
		1	15.83	0.83	0.66	8.672		
		1	9.00	0.83	0.66	4.930		
				Total-		138.862	3.930	m ³
9/5.3.15	Providing Av 63mm R.C.C M-150 in nominal mix of (1:2:4) in chajja with approved quality of stone chips 20mm to 6mm size graded and clean coarse sand of F.M 2.5mm to 3mm including making drip course in concrete, screening, shuttering, mixing cement concrete in mixer and placing in position, vibrating, striking, 6mm cement plaster (1:4) in ceiling and sides of chajja with sand of F.M.1.5, curing, (but excluding the cost of reinforcement) taxes and royalty all complete as per building specification and direction of E/I.							
		9	3.50	1.5		47.250		
		1	54.17	2		108.340		
				Total-		155.590	14.470	m ²
10/5.3.11	Providing R.C.C M-150 in nominal mix of (1:2:4) in beam of all type level with approved quality of stone chips 20mm to 6mm size graded and clean coarse sand of F.M 2.5mm to 3mm -do--taxes and royalty all complete as per building specification and direction of E/I.							
		2	21.66	1.5	0.83	53.933		
		1	22.50	0.83	0.83	15.500		
				total		69.434	1.965	m ³

82

11/5.3.9	Providing R.C.C M-150 in nominal mix of (1:2:4) in roof slab level with approved quality of stone chips 20mm to 6mm size graded and clean coarse sand of F.M 2.5mm to 3mm -do--taxes and royalty all complete as per building specification and direction of E/I.	1	55.17	29	0.375	599.974	
					total	599.974	16.979 m ³
12/5.7.3	Providing 12mm. cement plaster (1:6) with clean coarse sand of F.M.1.5. including screening, curing with all leads and lifts of water, scaffolding taxes and royalty all complete as per drawing specification and direction of E/I.	8	10.00	10		800.000	
		4	12.00	10		480.000	
		4	15.00	10		600.000	
		1	20.00	10		200.000	
		2	15.83	10		316.600	
		1	14.83	10		148.300	
		1	35.66	10		356.600	
		2	9.00	10		180.000	
		2	9.00	10		180.000	
		4	5.17	10		206.800	
	Outer side	2	54.17	12		1300.080	
		2	26.50	12		636.000	
		6	4.83	12		347.760	
		1	159.66	2.5		399.150	
					total	6151.290	
	less	2	4.00	3.5	7	196.000	
		2	1.00	3	7	42.000	
		2	1.00	2	7	28.000	
		2	12.00	3	4	288.000	
		2	1.00	9.17	7	128.380	
		2	2.00	10	7	280.000	
		10	2.00	1.5	1	30.000	
		2	2.00	3	1.5	18.000	
		2	5.00	3	1.5	45.000	
					total	1055.380	
					total	5095.910	473.920 m ²
13/5.7.6	Providing 6mm.thick cement plaster (1:4) in ceiling with clean coarse sand of F.M.1.5. including screening, curing with all leads and lifts of water, scaffolding taxes and royalty all complete as per drawing specification and direction of E/I.	2	12.00	10		240.000	
		1	15.83	20		316.600	
		2	15.00	10		300.000	
		1	35.66	9		320.940	
		1	5.17	9		46.530	
					total	1224.070	113.839 m ²
14/5.6.19(i)	Providing and laying 15-20 mm thick kotah stone slab flooring of approved quality over 19mm cement mortar (1:3) and joints filled with gray cement slurry, flush pointed with white cement -do- ,taxes and royalty all complete as per building specification and direction of E/I.	2	12.00	10		240.000	
		1	15.83	20		316.600	
		2	15.00	10		300.000	
		1	35.66	9		320.940	
		1	5.17	9		46.530	
	Step	3	11.66	1		34.980	
		4	11.66	0.5		23.320	

					1282.370	119.260	m ²
15/5.7.11	Providing 1.5mm thick cement punning including curing etc. complete job as per specification and direction of E/I.						
	plinth protection	1	159.66	2.5	399.150	37.121	m ²
16/5.6.23.4	Providing and laying 6mm precast white glazed tiles in wall over 12mm cement mortar (1:3) and joints filled with gray cement slurry, flush pointed with white cement -do- ,taxes and royalty all complete as per building specification and direction of E/I.						
		2	9.00	5	90.000		
		4	5.17	5	103.400		
				total	193.400		
	Less -Door	1	3.00	5	15.000		
		1	2.00	5	10.000		
				total	25.000		
				Net total	168.400	15.661	m ²
17/5.8.24	Providing two coat of snowcem of approved shade and make over a coat of cement primer on new surface including preparing the plastered surface smooth with sand paper, scaffolding, curing and taxes all complete as per building specification and direction of E/I.						
				Sum of Item no- 12&13		587.758	m ²
18/5.5.29	Providing and fixing glazing in Aluminum door, window, ventilator shutter and partition etc. with PVC/ neoprene gasket etc. complete as per the architectural drawing and the direction of E/I.						
		4	3.50	7	98.000		
		12	3.00	4	144.000		
				total	242.000	22.506	m ²
19/80020 D.S.R	30mm thick Factory made shutter with frame, rail and panels of PVC extruded sections in white, ,grey or wooden finish						
		1	3.00	7	21.000		
		1	2.00	7	14.000		
					35.000	3.255	m ²
20/5.5.18	Supplying, fitting, and fixing fully glazed steel doors & windows or ventilator of standard rolled 'Z' and mullion -do- in P.C.C. (1:2:4) blocks-do- a priming red lead paint over steel work, taxes all complete as per drawing specification and direction of E/I.						
		2	3.00	1.5	9.000	0.837	m ²
21/5.5.12	Supplying, fitting, and fixing M.S. grill made of 20x6mm M.S. flats as per approved design and drawing, properly fabricated, with joints continuous fillet welded and finished smooth, carriage of grill to site, hoisting as per specification and direction of E/I.						
		1	10.00	7	70.000		
		1	9.17	7	64.190		
		1	10.00	7	70.000		
		12	3.00	4	144.000		
		1	20.00	8.5	170.000		
					518.190	1036.380	Kg
22/5.5.13	Providing and fixing fan hook with -do- , all complete, as per specification & direction of E/I					12.000	Each
23/5.8.41+5 .8.43	Providing two coats of ready mixed paint of approved shade and make over steel surface including cleaning the surface thoroughly scaffolding, taxes all complete as per building specification and direction of E/I.						
		1.6	9.00		14.400		
		1.6	518.19		829.104		
					843.504	78.446	m ²

39

24/5.5.4	Providing Tor steel reinforcement above 8mm dia rods as per approved design and drawing excluding carriage of M S. Rods(straight or in coil) to work site, cutting, bending, and binding with annealed wire with cost of wire ,removal of rust, placing the rods in position all complete as per building specification and direction of E/I.			
	Item No-8		138.862	
	Item No-9		38.898	
	Item No-10		69.434	
	Item No-11		599.974	
		total	847.167	2.118 MT
25/5.10.34	Providing 150mm. wide brick drain in cement mortar(1:6) with av. 150mm. clear depth and 125mm apron including cost of earth work involved with 75mm cement concrete (1:4:3) over one brick designation 75 A, flat soling in proper grade and slope at the base the drain duty plastered in C.M.(1:3) with punning over exposed surface all complete as per building specification and direction of E/I.			
		1 159.66	159.660	48.664 M

26/ Chapter -III	<u>CARRIAGE OF MATERIAL</u>			
	ITEMS		KM	QUANTITY
	Sand	10	167.00	m ³
	Cement	10	40.20	mt
	Chips	30	90.29	m ³
	Bricks	15	63393.50	Nos
	Steel	10	2.12	mt

[Signature]
15/9/10
Assistant Engineer
Soil Conservation, Ranchi

[Signature]
15/9/10
Dy. Director (Engg)
Directorate, Jharkhand

PROPOSED PLAN OF AGRICULTURE TECHNOLOGY INFORMATION CENTER

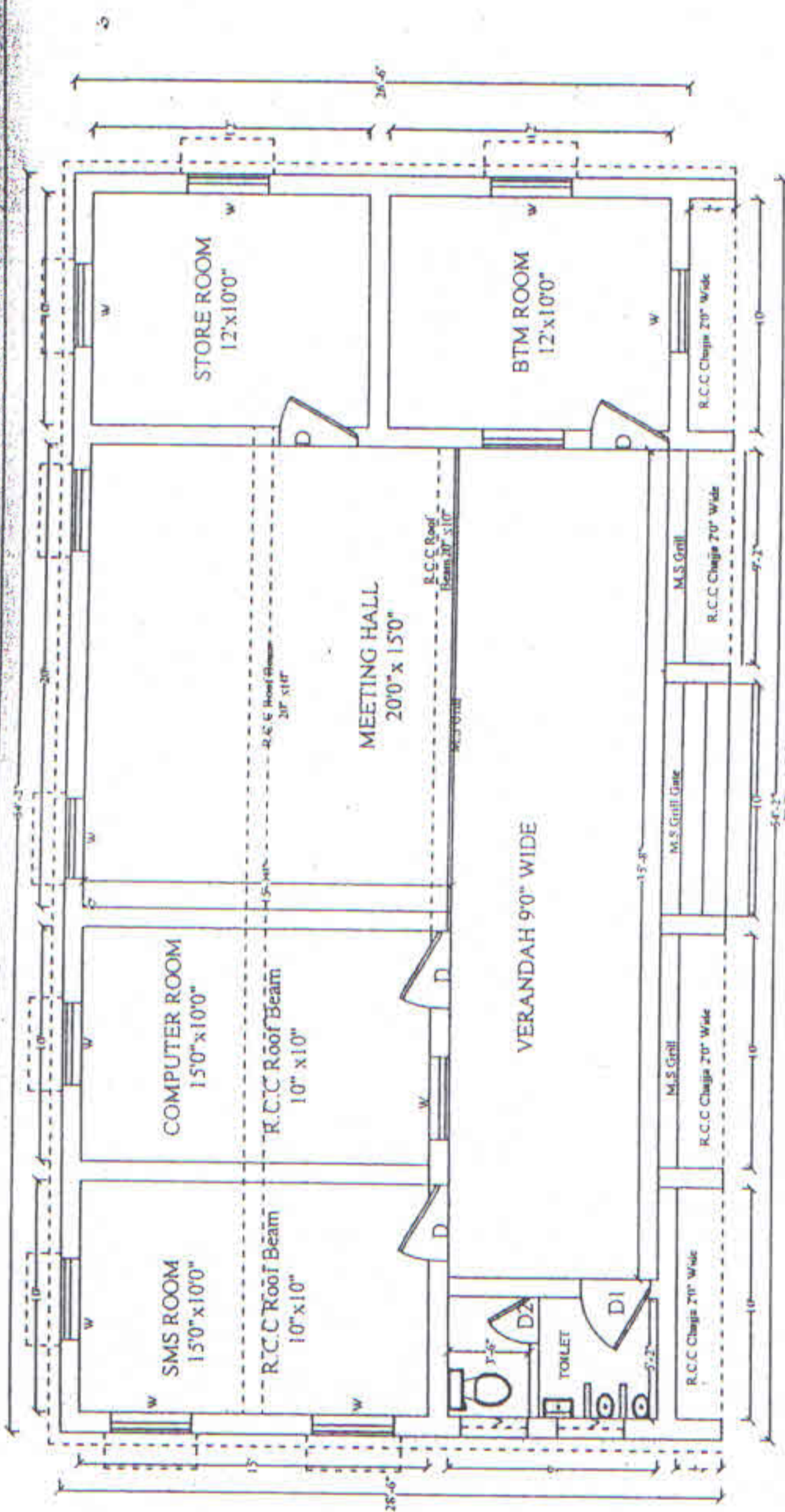

PLAN

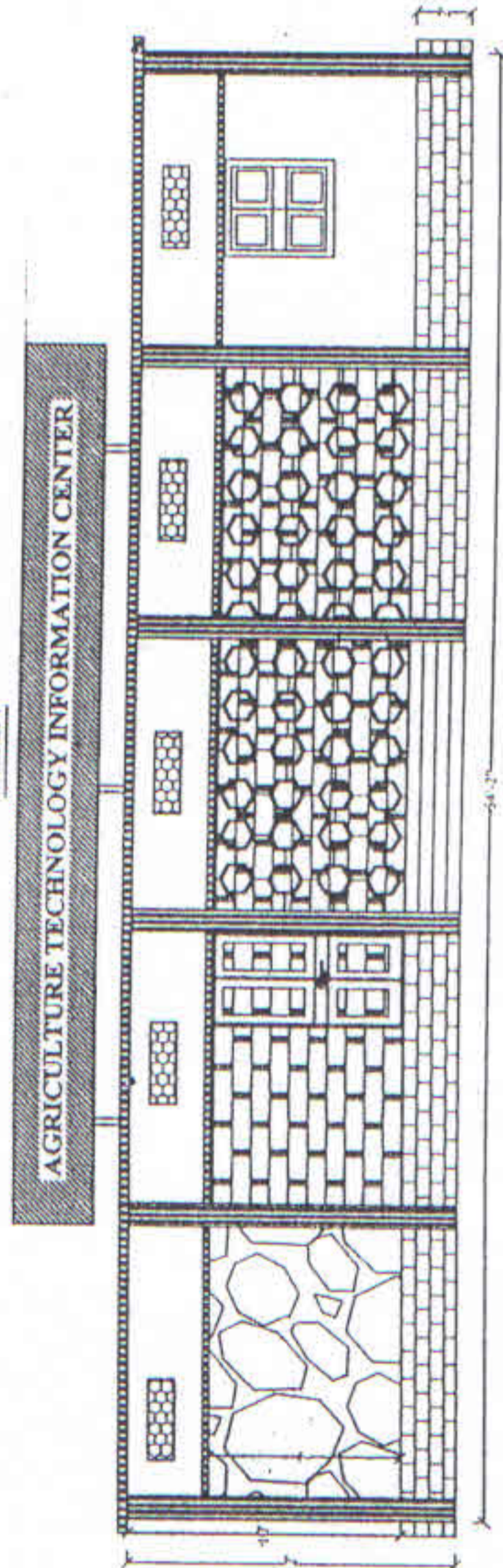

FRONT ELEVATION

OPENING SCHEDULE	
1	W. 30' x 40'
2	V. 30' x 10'
3	D. 30' x 70'
4	D. 30' x 70'
5	D. 20' x 70'

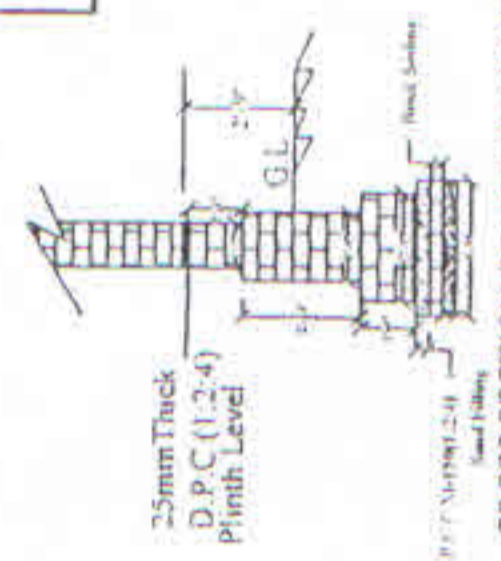

CROSS SECTION OF FOUNDATION

Prepared By - *Rakesh Kumar Choudhary*
 Rakesh Kumar Choudhary
 Assistant Engineer,
 Soil Conservation Ranchi, Jharkhand

35 B1

**ABSTRACT OF COST FOR CONSTRUCTION OF GENRATOR ROOM AT AGRICULTURE
TECHNOLOGY INFORMATION CENTER, JHARKHAND**

S.NO	PARTICULARS	QUANTITY	UNIT	RATE	AMOUNT
1/5.1.1	EW in excavation in foundation trenches in ordinary soil (vide classification of soil item -A) and disposal of excavated earth as obtained to a distance up to 50 M---do-- all complete as per approved design, building specification and direction of E/I.	9.195	M ³	48.07	441.99
2/5.1.10	Providing coarse clean sand in filling in foundation trenches or in plinth including ramming and watering in layers not exceeding 150mm---do-- all complete as per building specification and direction of E/I.	5.238	M ³	115.76	606.31
3/5.6.1	Providing designation 75A one brick flat soling joints filled with local sand including cost of watering taxes royalty all complete as building specification and direction of E/I.	21.295	M ²	122.92	2617.60
4/5.3.2	Providing P.C.C M-100 in nominal mix of (1:2:4) in foundation with approved quality of stone chips 20mm to 6mm size graded and clean coarse sand of F.M 2.5mm to 3mm -do-- all complete as per building specification and direction of E/I.	1.474	M ³	3493.58	5148.57
5/5.2.3	Providing designation 75A Brick work in C.M (1:6) in foundation with approved quality of clean coarse sand of F.M. 2 to 2.5 -do-- all complete as per building specification and direction of E/I	6.983	M ³	2164.22	15112.26
6/5.3.16	Providing 25mm thick damp proof course with cement concrete M-150 with nominal mix of (1:2:4) with approved quality of stone chips 20mm to 6mm size graded and clean coarse sand of F.M 2.5mm to 3mm -do--taxes and royalty all complete as per building specification and direction of E/I.	3.344	M ²	106.02	354.52
7/5.2.11	Providing designation 75A Brick work in C.M (1:6) in Super structure with approved quality of clean coarse sand of F.M. 2 to 2.5 -do-- all complete as per building specification and direction of E/I	8.083	M ³	2208.50	17850.80
8/5.3.8	Providing R.C.C M-150 in nominal mix of (1:2:4) in Lintel with approved quality of stone chips 20mm to 6mm size graded and clean coarse sand of F.M 2.5mm to 3mm -do--taxes and royalty all complete as per building specification and direction of E/I.	0.672	M ³	4412.45	2963.31
9/5.3.15	Providing Av 63mm R.C.C M-150 in nominal mix of (1:2:4) in chajja with approved quality of stone chips 20mm to 6mm size -do- all complete as per building specification and direction of E/I.	1.535	M ²	525.39	806.21
10/5.3.9	Providing R.C.C M-150 in nominal mix of (1:2:4) in roof slab level with approved quality of stone chips 20mm to 6mm size graded and clean coarse sand of F.M 2.5mm to 3mm -do--taxes and royalty all complete as per building specification and direction of E/I.	1.497	M ³	4467.93	6687.66
11/5.7.3	Providing 12mm. cement plaster (1:6) with clean coarse sand of F.M.1.5. including screening, curing with all leads and lifts of water, scaffolding taxes and royalty all complete as per drawing specification and direction of E/I.	77.997	M ²	60.88	4748.47
12/5.7.6	Providing 6mm.thick cement plaster (1:4) in ceiling with clean coarse sand of F.M.1.5. including screening, curing with all leads and lifts of water, scaffolding taxes and royalty all complete as per drawing specification and direction of E/I.	9.300	M ²	60.57	563.30
13/5.6.9	Providing 50mm thick cement concrete flooring (1:2:4) with 20mm to 6mm. size graded stone chips finished with flooring cost of neat cement in panels including cost of curing, finishing the surface smooth by rubbing with -do- all complete as per drawing specification and direction of E/I.	11.223	M ²	224.80	2522.98

02

34 30

14/5.8.24	Providing two coat of snowcem of approved shade and make over a coat of cement primer on new surface including preparing the plastered surface smooth with sand paper, scaffolding, curing and taxes all complete as per building specification and direction of E/I.	87.297	M ²	40.94	3573.95
15/5.5.29	Supplying, fitting, and fixing, 20 gauge G.C.I. sheet gate fitted on M.S. angle frame of size 60x60x6mm. including cost of fabrication, providing necessary locking arrangement with haskal and domny duty fixed in P.C.C. (1:2:4) blocks of required size, applying a priming red lead paint over steel work, taxes all complete as per drawing specification and direction of E/I.	4.511	M ²	1896.57	8554.48
16/5.5.18	Supplying, fitting, and fixing fully glazed steel doors & windows or ventilator of standard rolled 'Z' and mullion -do- in P.C.C. (1:2:4) blocks-do- a priming red lead paint over steel work, taxes all complete as per drawing specification and direction of E/I.	0.837	M ²	1719.55	1439.26
17/5.5.13	Providing and fixing fan hook with -do-, all complete, as per specification & direction of E/I	1.000	Each	72.27	72.27
18/5.8.41 +5.8.43	Providing two coats of ready mixed paint of approved shade and make over steel surface including cleaning the surface thoroughly scaffolding, taxes all complete as per building specification and direction of E/I.	9.021	M ²	55.81	503.46
19/5.5.4	Providing Tor steel reinforcement above 8mm dia rods as per approved design and drawing excluding carriage of M S. Rods(straight or in coil) to work site, cutting, bending, and binding with annealed wire with cost of wire ,removal of rust, placing the rods in position all complete as per building specification and direction of E/I.	0.202	Mt	43724.78	8826.57
TOTAL-					83393.97
20/ Chap -III	CARRIAGE OF MATERIAL				
	ITEMS	QUANTITY	KM	RATE	
	Sand	14.6797 m ³	10	162.78	2389.57
	Cement	3.6108 mt	10	101.74	367.36
	Chips	5.2789 m ³	30	295.98	1562.44
	Bricks	6804.4340 No	15	495.44	3371.19
	Steel	0.2019 mt	10	101.74	20.54
	TOTAL-				91105.07

Say Rs-91,100/-

RS-91,100/- (NINETY ONE THOUSAND ONE HUNDRED) ONLY

(Signature)
15/9/10
Assistant Engineer
Soil Conservation, Ranchi

(Signature)
15/9/10
Dy. Director (Engg)
Directorate, Jharkhand

MATERIAL STATEMENT

ITEM NO.	WORKS	QUANTITY	SAND	CEMENT	CHIPS	BRICKS
5.1.1	E/W	9.1947				
5.1.10	Sand Filling	5.2376	5.2376			
5.2.3	Brick Work (1:6) in foundation	6.983	2.3951	0.3980		2835.4947
5.2.14	Brick Work (1:6) in Superstructure	8.083	2.7724	0.4607		3282.1711
5.3.2	PCC (1:2:4)	1.4737	0.6632	0.3316	1.3264	
5.3.8	Lintel	0.672	0.3022	0.1511	0.6044	
5.3.9	Roof Slab (1:2:4)	1.4968	0.6736	0.3368	1.3471	
5.3.15	Chajja	1.535	0.6905	0.3453	1.3811	
5.3.16	DPC	3.344	0.0512	0.0254	0.1037	
5.6.1	Brick flat Soling	21.295	0.3194			686.7683
5.6.9	Concrete flooring 50mm thick (1:2:4)	11.223	0.2615	0.1369	0.5163	
5.7.3	Plaster (1:6)	77.997	1.2480	0.2028		
5.7.6	Ceiling Plaster (1:4)	9.300	0.0651	0.0186		
TOTAL-			14.6797m ³	2.4072m ³	5.2789m ³	6804.4340 nos
				3.6108mt		

CARRIAGE OF MATERIAL

ITEMS	QUANTITY	KM
Sand	14.6797 m ³	10
Cement	3.6108 m.t	10
Chips	5.2789 m ³	30
Bricks	6804.4340 No	15
Steel	0.2019 m.t	10

Assistant Engineer
 Soil Conservation, Ranchi

Dy. Director (Engg)
 Directorate, Jharkhand

3228

**DETAIL ESTIMATE FOR CONSTRUCTION OF GENRATOR ROOM AT AGRICULTURE TECHNOLOGY
INFORMATION CENTER, JHARKHAND**

S.NO	PARTICULARS	NOS	L	B	H	QUANTITY	
1/5.1.1	E\W in excavation in foundation trenches in ordinary soil (vide classification of soil item -A) and disposal of excavated earth as obtained to a distance up to 50 M---do-- all complete as per approved design, building specification and direction of E/I.	2	13.33	2.5	3	199.950	
		2	8.33	2.5	3	124.950	
		total				324.900	9.195 M ³
2/5.1.10	Providing coarse clean sand in filling in foundation trenches or in plinth including ramming and watering in layers not exceeding 150mm---do-- all complete as per building specification and direction of E/I.	2	13.33	2.5	0.25	16.663	
		2	8.33	2.5	0.25	10.413	
		1	10	10	1.58	158.000	
		total				185.075	5.238 M ³
3/5.6.1	Providing designation 75A one brick flat soling joints filled with local sand including cost of watering taxes royalty all complete as building specification and direction of E/I.	2	13.33	2.5		66.650	
		2	8.33	2.5		41.650	
		1	10	10		100.000	
		1	5.17	4		20.680	
		total				228.980	21.295 M ³
4/5.3.2	Providing P.C.C M-100 in nominal mix of (1:2:4) in foundation with approved quality of stone chips 20mm to 6mm size graded and clean coarse sand of F.M 2.5mm to 3mm -do-- all complete as per building specification and direction of E/I.	2	13.33	2.5	0.25	16.663	
		2	8.33	2.5	0.25	10.413	
		1	10	10	0.25	25.000	
		total				52.075	1.474 M ³
5/5.2.3	Providing designation 75A Brick work in C.M (1:6) in foundation with approved quality of clean coarse sand of F.M. 2 to 2.5 -do-- all complete as per building specification and direction of E/I	2	12.83	2	1	51.320	
1st footing		2	8.83	2	1	35.320	
2nd Footing		2	12.08	1.25	2.17	65.534	
		2	9.58	1.25	2.17	51.972	
3rd footing		2	11.66	0.83	1	19.356	
		2	10	0.83	1	16.600	
Ramp		1	4	0.83	2	6.640	
		total				246.741	6.983 M ³
6/5.3.16	Providing 25mm thick damp proof course with cement concrete M-150 with nominal mix of (1:2:4) with approved quality of stone chips 20mm to 6mm size graded and clean coarse sand of F.M 2.5mm to 3mm -do--taxes and royalty all complete as per building specification and direction of E/I.	2	11.66	0.83		19.356	
		2	10	0.83		16.600	
		total-				35.956	3.844 M ²

7/5.2.11	Providing designation 75A Brick work in C.M (1:6) in Super structure with approved quality of clean coarse sand of F.M. 2 to 2.5 -do-- all complete as per building specification and direction of E/I	2	11.66	0.83	10	193.556	
		2	10	0.83	10	166.000	
					Total-	359.556	
	Less- Door	1	3.5	0.83	7	20.335	
	Window	2	3	0.83	4	19.920	
	Lintel	1	43.32	0.83	0.66	23.731	
	Ventilator	2	1.5	0.83	1	2.490	
	grill window	2	3	0.83	1.5	7.470	
					Total-	73.946	
					Net Total-	285.610	8.083 M ³
8/5.3.8	Providing R.C.C M-150 in nominal mix of (1:2:4) in Lintel with approved quality of stone chips 20mm to 6mm size graded and clean coarse sand of F.M 2.5mm to 3mm -do--taxes and royalty all complete as per building specification and direction of E/I.	2	11.66	0.83	0.66	12.775	
		2	10	0.83	0.66	10.956	
					Total-	23.731	0.672 M ³
9/5.3.15	Providing Av 63mm R.C.C M-150 in nominal mix of (1:2:4) in chajja with approved quality of stone chips 20mm to 6mm size graded and clean coarse sand of F.M 2.5mm to 3mm including making drip course in concrete, screening, shuttering, mixing cement concrete in mixer and placing in position, vibrating, striking, 6mm cement plaster (1:4) in ceiling and sides of chajja with sand of F.M.1.5, curing, (but excluding the cost of reinforcement) taxes and royalty all complete as per building specification and direction of E/I.	2	3.5	1.5		10.500	
		1	4	1.5		6.000	
					Total-	16.500	1.535 M ³
10/5.3.9	Providing R.C.C M-150 in nominal mix of (1:2:4) in roof slab level with approved quality of stone chips 20mm to 6mm size graded and clean coarse sand of F.M 2.5mm to 3mm -do--taxes and royalty all complete as per building specification and direction of E/I.	1	12.66	12.66	0.33	52.891	
					total	52.891	1.497 M ³
11/5.7.3	Providing 12mm. cement plaster (1:6) with clean coarse sand of F.M.1.5. including screening, curing with all leads and lifts of water, scaffolding taxes and royalty all complete as per drawing specification and direction of E/I.	4	10	10		400.000	
	Outer side	4	11.66	12		559.680	
					total	959.680	
	less	2	1	3.5	7	49.000	
		2	2	3	4	48.000	
		2	2	1.5	1	6.000	
		2	2	3	1.5	18.000	
					total	121.000	
					total	838.680	77.997 M ²

12/5.7.6	Providing 6mm.thick cement plaster (1:4) in ceiling with clean coarse sand of F.M.1.5. including screening, curing with all leads and lifts of water, scaffolding taxes and royalty all complete as per drawing specification and direction of E/I.	1	10.00	10	100.000	9.300	M ²
		total			100.000		
13/5.6.9	Providing 50mm thick cement concrete flooring (1:2:4) with 20mm to 6mm. size graded stone chips finished with flooring cost of neat cement in panels including cost of curing, finishing the surface smooth by rubbing with -do- all complete as per drawing specification and direction of E/I.	1	10.00	10	100.000	11.223	M ²
		1	5.17	4	20.680		
		total			120.680		
14/5.8.24	Providing two coat of snowcem of approved shade and make over a coat of cement primer on new surface including preparing the plastered surface smooth with sand paper, scaffolding, curing and taxes all complete as per building specification and direction of E/I.	Sum of item No-12& 13				87.297	M ²
15/5.5.29	Supplying, fitting, and fixing, 20 gauge G.C.I. sheet gate fitted on M.S. angle frame of size 60x60x6mm. including cost of fabrication, providing necessary locking arrangement with haskal and domny duty fixed in P.C.C. (1:2:4) blocks of required size, applying a priming red lead paint over steel work, taxes all complete as per drawing specification and direction of E/I.	1	3.5	7	24.500	4.511	M ²
		2	3	4	24.000		
		total			48.500		
16/5.5.18	Supplying, fitting, and fixing fully glazed steel doors & windows or ventilator of standard rolled 'Z' and mullion -do- in P.C.C. (1:2:4) blocks-do- a priming red lead paint over steel work, taxes all complete as per drawing specification and direction of E/I.	2	3	1.5	9.000	0.837	M ²
17/5.5.13	Providing and fixing fan hook with -do-, all complete, as per specification & direction of E/I					1.000	Each
18/5.8.41+5.8.43	Providing two coats of ready mixed paint of approved shade and make over steel surface including cleaning the surface thoroughly scaffolding, taxes all complete as per building specification and direction of E/I.	2	48.500		97.000	9.021	M ²
		total			97.000		

29 28

19/5.5.4	Providing Tor steel reinforcement above 8mm dia rods as per approved design and drawing excluding carriage of M S. Rods(straight or in coil) to work site, cutting, bending, and binding with annealed wire with cost of wire ,removal of rust, placing the rods in position all complete as per building specification and direction of E/I.	
	Item No-8	23.731
	Item No-9	4.125
	Item No-10	52.891
	total	80.747
		0.202 Mt

20/Chapter -III	<u>CARRIAGE OF MATERIAL</u>		
	ITEM S	Km	Quantity
	Sand	10	14.6797 m ³
	Cement	10	3.6108 mt
	Chips	30	5.2789 m ³
	Bricks	15	6804.4340 Nos
	Steel	10	0.2019 rpt

AS
15/9/10
Assistant Engineer
Soil Conservation, Ranchi

Shubh
15/9/10
Dy. Director (Engg)
Directorate, Jharkhand

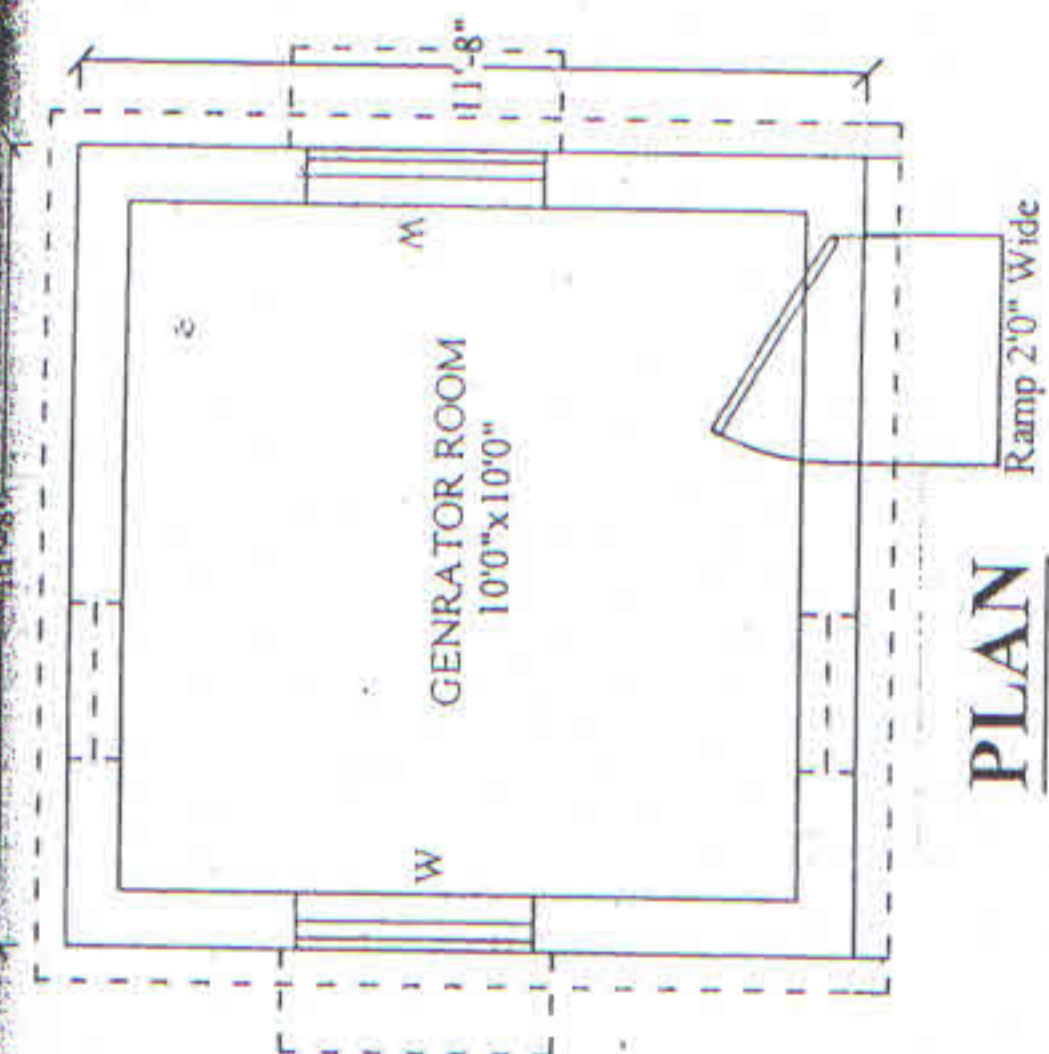

PLAN

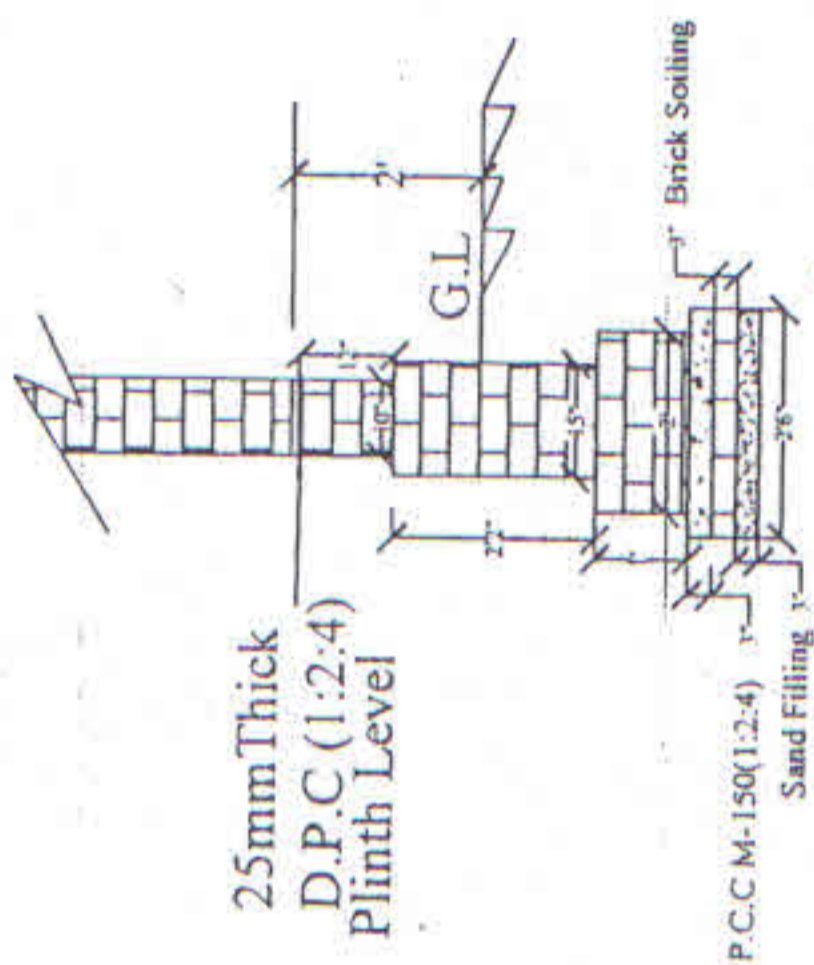

CROSS SECTION OF FOUNDATION

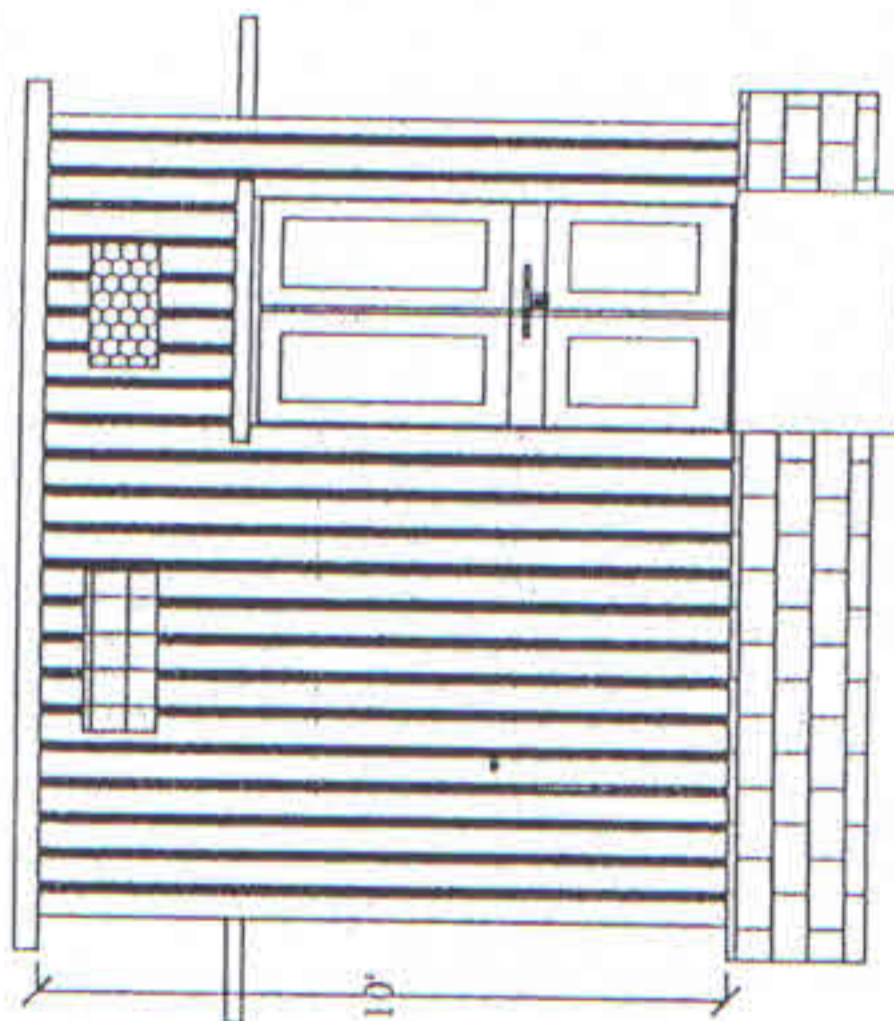

FRONT ELEVATION

Prepared By - *Rakesh Kumar Choudhary*
 Rakesh Kumar Choudhary
 Assistant Engineer,
 Soil Conservation Ranchi, Jharkhand

PROPOSED PLAN OF GENRATOR ROOM AT A.T.I CENTER, JHARKHAND

27 23

✓

**ABSTRACT OF COST FOR CONSTRUCTION OF SEPTIC TANK & TOILET AT AGRICULTURE
TECHNOLOGY INFORMATION CENTER, JHARKHAND**

S. NO	PARTICULARS	QUANTITY	UNIT	RATE	AMOUNT
1/5.1.1	EW in excavation in foundation trenches in ordinary soil (vide classification of soil item -A) and disposal of excavated earth as obtained to a distance up to 50 M---do-- all complete as per approved design, building specification and direction of E/I.	15.434	M ³	48.07	741.92
2/5.1.10	Providing coarse clean sand in filling in foundation trenches or in plinth including ramming and watering in layers not exceeding 150mm---do-- all complete as per building specification and direction of E/I.	1.826	M ³	115.76	211.41
3/5.6.1	Providing designation 75A one brick flat soling joints filled with local sand including cost of watering taxes royalty all complete as building specification and direction of E/I.	13.126	M ²	122.92	1613.45
4/5.3.2	Providing P.C.C M-100 in nominal mix of (1:2:4) in foundation with approved quality of stone chips 20mm to 6mm size graded and clean coarse sand of F.M 2.5mm to 3mm --do-- all complete as per building specification and direction of E/I.	0.843	M ³	3493.58	2945.04
5/5.2.3	Providing designation 75A Brick work in C.M (1:6) in foundation with approved quality of clean coarse sand of F.M. 2 to 2.5 --do-- all complete as per building specification and direction of E/I	7.448	M ³	2164.22	16119.10
6/5.3.16	Providing 25mm thick damp proof course with cement concrete M-150 with nominal mix of (1:2:4) with approved quality of stone chips 20mm to 6mm size graded and clean coarse sand of F.M 2.5mm to 3mm --do--taxes and royalty all complete as per building specification and direction of E/I.	3.448	M ²	106.02	365.55
7/5.2.11	Providing designation 75A Brick work in C.M (1:6) in Super structure with approved quality of clean coarse sand of F.M. 2 to 2.5 --do-- all complete as per building specification and direction of E/I	4.396	M ³	2208.50	9709.27
8/5.3.8	Providing R.C.C M-150 in nominal mix of (1:2:4) in Lintel with approved quality of stone chips 20mm to 6mm size graded and clean coarse sand of F.M 2.5mm to 3mm --do--taxes and royalty all complete as per building specification and direction of E/I.	0.074	M ³	4412.45	324.92
9/5.3.15	Providing Av 63mm R.C.C M-150 in nominal mix of (1:2:4) in chajja with approved quality of stone chips 20mm to 6mm size graded and clean coarse sand of F.M 2.5mm to 3mm including making drip course in concrete, screening, shuttering, mixing cement concrete in mixer and placing in position, vibrating, striking, 6mm cement plaster (1:4) in ceiling and sides of chajja with sand of F.M.1.5, curing, (but excluding the cost of reinforcement) taxes and royalty all complete as per building specification and direction of E/I.	0.419	M ³	525.39	219.88
10/5.3.11	Providing R.C.C M-150 in nominal mix of (1:2:4) in beam of all type level with approved quality of stone chips 20mm to 6mm size graded and clean coarse sand of F.M 2.5mm to 3mm --do--taxes and royalty all complete as per building specification and direction of E/I.	0.101	M ³	5338.87	538.12
11/5.3.9	Providing R.C.C M-150 in nominal mix of (1:2:4) in roof slab level with approved quality of stone chips 20mm to 6mm size graded and clean coarse sand of F.M 2.5mm to 3mm --do--taxes and royalty all complete as per building specification and direction of E/I.	0.777	M ³	4467.93	3470.25

✓

74 22

12/5.7.3	Providing 12mm. cement plaster (1:6) with clean coarse sand of F.M.1.5. including screening, curing with all leads and lifts of water, scaffolding taxes and royalty all complete as per drawing specification and direction of E/I.	63.241	M ²	60.88	3850.11
13/5.7.6	Providing 6mm.thick cement plaster (1:4) in ceiling with clean coarse sand of F.M.1.5. including screening, curing with all leads and lifts of water, scaffolding taxes and royalty all complete as per drawing specification and direction of E/I.	1.139	M ²	60.57	69.00
14/5.7.11	Providing 1.5mm thick cement punning including curing etc. complete job as per specification and direction of E/I.	35.619	M ²	23.63	841.68
15/5.6.9	Providing 50mm thick cement concrete flooring (1:2:4) with 20mm to 6mm. size graded stone chips finished with flooring cost of neat cement in panels including cost of curing, finishing the surface smooth by rubbing with -do- all complete as per drawing specification and direction of E/I.	3.011	M ²	224.80	676.84
16/5.8.24	Providing two coat of snowcem of approved shade and make over a coat of cement primer on new surface including preparing the plastered surface smooth with sand paper, scaffolding, curing and taxes all complete as per building specification and direction of E/I.	64.380	M ²	40.94	2635.72
17/5.5.29	Supplying, fitting, and fixing, 20 gauge G.C.I. sheet gate fitted on M.S. angle frame of size 60x60x6mm. including cost of fabrication, providing necessary locking arrangement with haskal and domny duty fixed in P.C.C. (1:2:4) blocks of required size, applying a priming red lead paint over steel work, taxes all complete as per drawing specification and direction of E/I.	1.395	M ²	1896.57	2645.72
18/5.8.41 +5.8.43	Providing two coats of ready mixed paint of approved shade and make over steel surface including cleaning the surface thoroughly scaffolding, taxes all complete as per building specification and direction of E/I	2.790	M ²	55.81	155.71
19/5.5.4	Providing Tor steel reinforcement above 8mm dia rods as per approved design and drawing excluding carriage of M S. Rods(straight or in coil) to work site, cutting, bending, and binding with annealed wire with cost of wire ,removal of rust, placing the rods in position all complete as per building specification and direction of E/I.	0.087	MT	43724.78	3796.83

Q

25/24

20/12.3.7	supplying materials & labours for constructing inspection chamber of designation class 75B bricks 750mm deep, 600x450mm internal dimension having 250mm wall thickness in cement mortar(1:6) including 12mm plaster(1:4) with punning on inside and cement plaster(1:6) with 600x475mm G.I cover with frame along with earthwork in excavation and 80mm thick P.C.C(1:3:6) in foundation and refilling all complete as per specification and direction of E/I.	3.000	Each	4589.64	13768.92
TOTAL-					64699.45
21/ Chap -III	<u>CARRIAGE OF MATERIAL</u>				
	ITEMS	QUANTITY	KM	RATE	
	Sand	8.2242 m ³	10	162.78	1338.73
	Cement	2.2108mt	10	101.74	224.92
	Chips	2.2367m ³	30	295.98	662.03
	Bricks	5232.934nos	15	495.44	2592.60
	Steel	0.0868 mt	10	101.74	8.83
	TOTAL				69526.57

Say Rs- 69,500/-

Rs- 69,500/- (SIXTY NINE THOUSAND FIVE HUNDRED) ONLY

Assistant Engineer
Soil Conservation, Ranchi

Dy. Director (.Engg)
Directorate, Jharkhand

MATERIAL STATEMENT

ITEM NO.	WORKS	QUANTITY	SAND	CEMENT	CHIPS	BRICKS
5.1.1	E/W	15.43411	.			
5.1.10	Sand Filling	1.826247	1.8262471			
5.2.3	Brick Work (1:6) in foundation	7.448	2.5546619	0.4245357		3024.407
5.2.14	Brick Work (1:6) in Superstructure	4.396	1.5079373	0.2505902		1785.213
5.3.2	PCC (1:2:4)	0.8430	0.3793438	0.1896719	0.75869	
5.3.8	Lintal	0.074	0.0331371	0.0165686	0.06627	
5.3.9	Roof Slab	0.7767	0.3495156	0.1747578	0.69903	
5.3.10	Beam	0.1008	0.0453571	0.0226786	0.09071	
5.3.15	Chajja	0.419	0.188325	0.0941625	0.37665	
5.3.16	DPC	3.448	0.052754	0.0262046	0.10689	
5.6.1	Brick flat Soling	13.12602	0.1968903			423.314
5.6.9	Concrete flooring 50mm thick (1:2:4)	3.011	0.0701534	0.0367327	0.1385	
5.7.3	Plaster (1:6)	63.241	1.0118549	0.1644264		
5.7.6	Ceiling Plaster (1:4)	1.139	0.0079748	0.0022785		
5.7.11	Punning 1.5mm	35.619		0.071238		
5.8.24	Snowcem	64.38018				
Total			8.2242m ³	1.47384 m ³	2.2367 m ³	5232.934Nos
				2.2108mt		

CARRIAGE OF MATERIAL

ITEMS	QUANTITY	KM
Sand	8.2242 m ³	10
Cement	2.2108mt	10
Chips	2.2367m ³	30
Bricks	5232.934nos	15
Steel	0.0868 mt	10

(Signature)
Assistant Engineer

Soil Conservation, Ranchi

(Signature)
Dy. Director (Engg)

Directorate, Jharkhand

23/19

**ABSTRACT OF COST FOR CONSTRUCTION OF SEPTIC TANK & TOILET AT AGRICULTURE
TECHNOLOGY INFORMATION CENTER, JHARKHAND**

S. NO	PARTICULARS	NOS	L	B	H	QUANTITY
1/5.1.1	E\W in excavation in foundation trenches in ordinary soil (vide classification of soil item -A) and disposal of excavated earth as obtained to a distance up to 50 M---do-- all complete as per approved design, building specification and direction of E/I.	1	9	5	8	360.000
		2	13	2.5	2.5	162.500
		2	1.83	2.5	2.5	22.875
		total				545.375
						15.434 m ³
2/5.1.10	Providing coarse clean sand in filling in foundation trenches or in plinth including ramming and watering in layers not exceeding 150mm---do-- all complete as per building specification and direction of E/I.	1	9	5	0.25	11.250
		2	13	2.5	0.25	16.250
		2	1.83	2.5	0.25	2.288
		1	7.33	3	1.58	34.744
		total				64.532
						1.826 m ³
3/5.6.1	Providing designation 75A one brick flat soling joints filled with local sand including cost of watering taxes royalty all complete as building specification and direction of E/I.	1	9	5		45.000
		2	13	2.5		65.000
		2	1.83	2.5		9.150
		1	7.33	3		21.990
		total				141.140
						13.126 m ²
4/5.3.2	Providing P.C.C M-100 in nominal mix of (1:2:4) in foundation with approved quality of stone chips 20mm to 6mm size graded and clean coarse sand of F.M 2.5mm to 3mm -do-- all complete as per building specification and direction of E/I.	1	9	5	0.25	11.250
		2	13	2.5	0.25	16.250
		2	1.83	2.5	0.25	2.288
						29.788
						0.843 m ³
5/5.2.3	Providing designation 75A Brick work in C.M (1:6) in foundation with approved quality of clean coarse sand of F.M. 2 to 2.5 -do-- all complete as per building specification and direction of E/I	1	9	0.83	8	59.760
	1st footing	2	3	0.83	8	39.840
		1	3	0.42	7.5	9.450
		2	12.5	2	0.75	37.500
		2	2.33	2	0.75	6.990
	2nd Footing	2	9	1.5	1	27.000
		2	2.83	1.5	1	8.490
	3rd footing	2	11.75	1.25	2	58.750
		2	3.08	1.25	2	15.400
						263.180
						7.448 m ³
6/5.3.16	Providing 25mm thick damp proof course with cement concrete M-150 with nominal mix of (1:2:4) with approved quality of stone chips 20mm to 6mm size graded and clean coarse sand of F.M 2.5mm to 3mm -do--taxes and royalty all complete as per building specification and direction of E/I.	2	11.75	1.25		29.375
		2	3.08	1.25		7.700
		total-				37.075
						3.448 m ²

7/5.2.11	Providing designation 75A Brick work in C.M (1:6) in Super structure with approved quality of clean coarse sand of F.M. 2 to 2.5 –do-- all complete as per building specification and direction of E/I	2	4.75	0.83	8	63.080	4.396 m ³
		1	3.5	0.83	8	23.240	
		1	3.5	0.83	8	23.240	
		2	6.58	0.83	5	54.614	
		1	3.5	0.83	5	14.525	
		Total-				178.699	
		1	2.5	0.83	6	12.450	
		1	2	0.83	5	8.300	
		1	4.75	0.83	0.66	2.602	
		Total-				23.352	
Net Total-				155.347			
8/5.3.8	Providing R.C.C M-150 in nominal mix of (1:2:4) in Lintel with approved quality of stone chips 20mm to 6mm size graded and clean coarse sand of F.M 2.5mm to 3mm –do--taxes and royalty all complete as per building specification and direction of E/I.	1	4.75	0.83	0.66	2.602	0.074 m ³
		Total-				2.602	
9/5.3.15	Providing Av 63mm R.C.C M-150 in nominal mix of (1:2:4) in chajja with approved quality of stone chips 20mm to 6mm size graded and clean coarse sand of F.M 2.5mm to 3mm including making drip course in concrete, screening, shuttering, mixing cement concrete in mixer and placing in position, vibrating, striking, 6mm cement plaster (1:4) in ceiling and sides of chajja with sand of F.M.1.5, curing, (but excluding the cost of reinforcement) taxes and royalty all complete as per building specification and direction of E/I.	1	3	1.5		4.500	0.419 m ³
		Total-				4.500	
10/5.3.11	Providing R.C.C M-150 in nominal mix of (1:2:4) in beam of all type level with approved quality of stone chips 20mm to 6mm size graded and clean coarse sand of F.M 2.5mm to 3mm –do--taxes and royalty all complete as per building specification and direction of E/I.	1	5.17	0.83	0.83	3.562	0.101 m ³
		total				3.562	
11/5.3.9	Providing R.C.C M-150 in nominal mix of (1:2:4) in roof slab level with approved quality of stone chips 20mm to 6mm size graded and clean coarse sand of F.M 2.5mm to 3mm –do--taxes and royalty all complete as per building specification and direction of E/I.	1	9	4.66	0.33	13.840	0.777 m ³
		1	5.75	7.17	0.33	13.605	
		total				27.445	

12/5.7.3	Providing 12mm. cement plaster (1:6) with clean coarse sand of F.M.I.5. including screening, curing with all leads and lifts of water, scaffolding taxes and royalty all complete as per drawing specification and direction of E/I.					
		2	9	8	144.000	
		4	3	8	96.000	
		4	3.5	8	112.000	
		2	5.75	5	57.500	
		1	3.5	5	17.500	
		1	3.5	8	28.000	
		1	5.17	10	51.700	
		2	4.75	10	95.000	
		2	6.58	7	92.120	
		1	5.17	7	36.190	
		total				730.010
	Less- Door Opening	2	1	2.5	6	30.000
		2	1	2	5	20.000
		total				50.000
		total				680.010
13/5.7.6	Providing 6mm.thick cement plaster (1:4) in ceiling with clean coarse sand of F.M.I.5. including screening, curing with all leads and lifts of water, scaffolding taxes and royalty all complete as per drawing specification and direction of E/I.	1	3.5	3.5	12.250	1.139 m ²
14/5.7.11	Providing 1.5mm thick cement punning including curing etc. complete job as per specification and direction of E/I.	1	9.00	3	27.000	
		2	9.00	8	144.000	
		4	3.00	8	96.000	
		4	3.50	3	42.000	
		2	5.75	4	46.000	
		2	3.50	4	28.000	
		total				383.000
						35.619 m ²
15/5.6.9	Providing 50mm thick cement concrete flooring (1:2:4) with 20mm to 6mm. size graded stone chips finished with flooring cost of neat cement in panels including cost of curing, finishing the surface smooth by rubbing with -do- all complete as per drawing specification and direction of E/I.	1	3.50	3.5	12.250	
		1	5.75	3.5	20.125	
						32.375
						3.011 m ²
16/5.8.24	Providing two coat of snowcem of approved shade and make over a coat of cement primer on new surface including preparing the plastered surface smooth with sand paper, scaffolding, curing and taxes all complete as per building specification and direction of E/I.					
	Sum of item no-12&13					64.380 m ²
17/5.5.29	Supplying, fitting, and fixing, 20 gauge G.C.I. sheet gate fitted on M.S. angle frame of size 60x60x6mm. including cost of fabrication, providing necessary locking arrangement with haskal and domny duty fixed in P.C.C. (1:2:4) blocks of required size, applying a priming red lead paint over steel work, taxes all complete as per drawing specification and direction of E/I.	1	2.5	6	15.000	
						15.000
						1.395 m ²
18/5.8.41+ 5.8.43	Providing two coats of ready mixed paint of approved shade and make over steel surface including cleaning the surface thoroughly scaffolding, taxes all complete as per building specification and direction of E/I.	2	15.000		30.000	
						30.000
						2.790 m ²

32

20/16

19/5.5.4	Providing Tor steel reinforcement above 8mm dia rods as per approved design and drawing excluding carriage of M S. Rods(straight or in coil) to work site, cutting, bending, and binding with annealed wire with cost of wire ,removal of rust, placing the rods in position all complete as per building specification and direction of E/I.			
	Item no-8		2.602	
	Item no-9		1.125	
	Item no-10		3.562	
	Item no-11		27.445	
	total		34.734	0.087 MT
20/12.3.7	supplying materials & labours for constructing inspection chamber of designation class 75B bricks 750mm deep, 600x450mm internal dimension having 250mm wall thickness in cement mortar (1:6) including 12mm plaster(1:4) with punning on inside and cement plaster(1:6) with 600x475mm G.I cover with frame along with earthwork in excavation and 80mm thick P.C.C(1:3:6) in foundation and refilling all complete as per specification and direction of E/I.			3.000 each
21/ Chapter - III	<u>CARRIAGE OF MATERIAL</u>			
	Item No	Km	Quantity	
	Sand	10	8.2242	m ³
	Cement	10	2.2108	mt
	Chips	30	2.2367	m ³
	Bricks	15	5232.9342	Nos
	Steel	10	0.0868	mt

Assistant Engineer
 Soil Conservation, Ranchi

Dy. Director (Engg)
 Directorate, Jharkhand

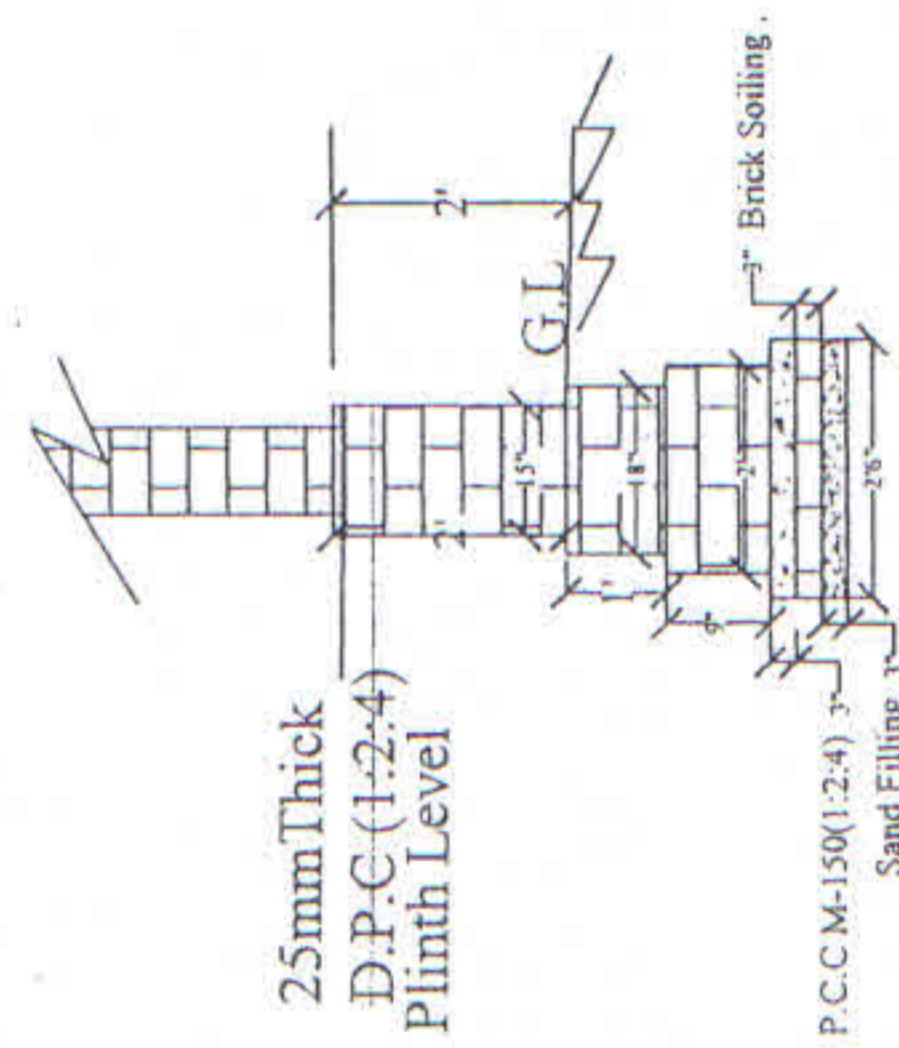
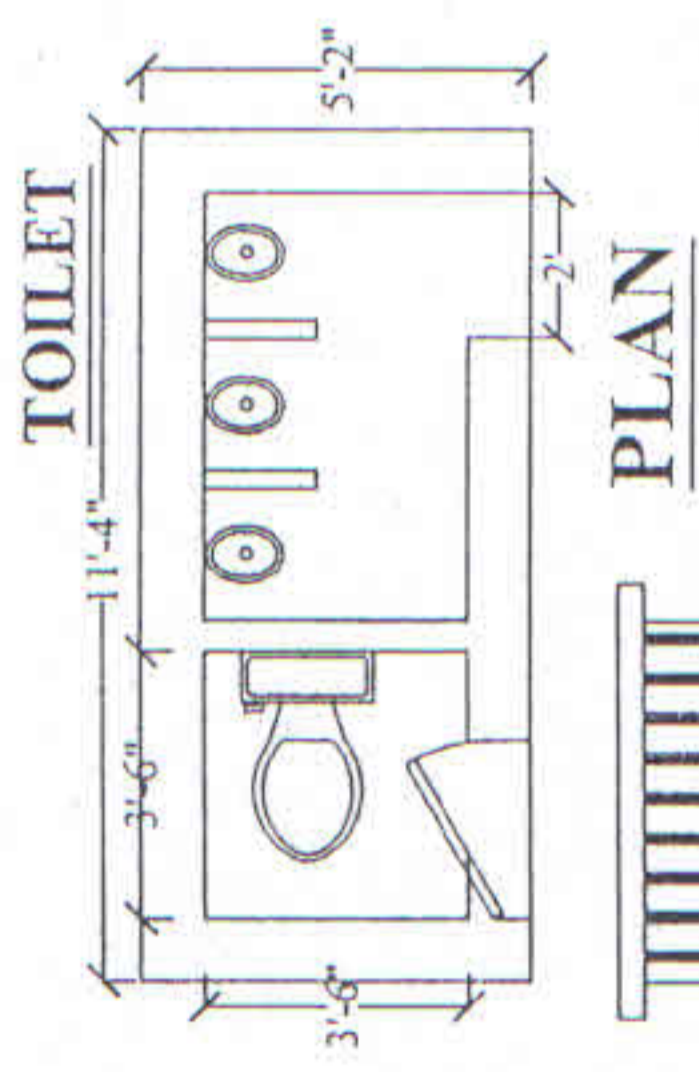
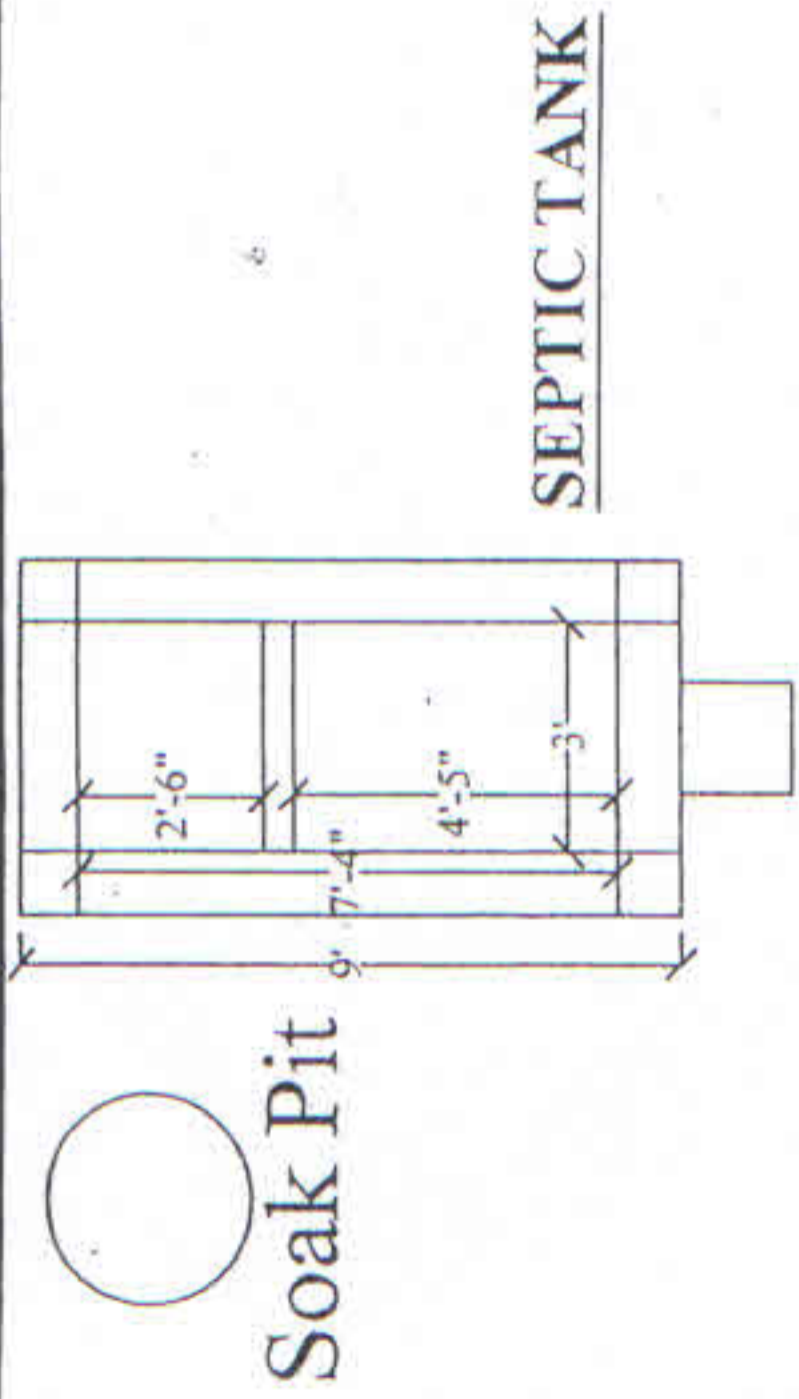

Prepared By: *[Signature]*
 Rakesh Kumar Choudhary
 Assistant Engineer,
 Soil Conservation Ranchi, Jharkhand

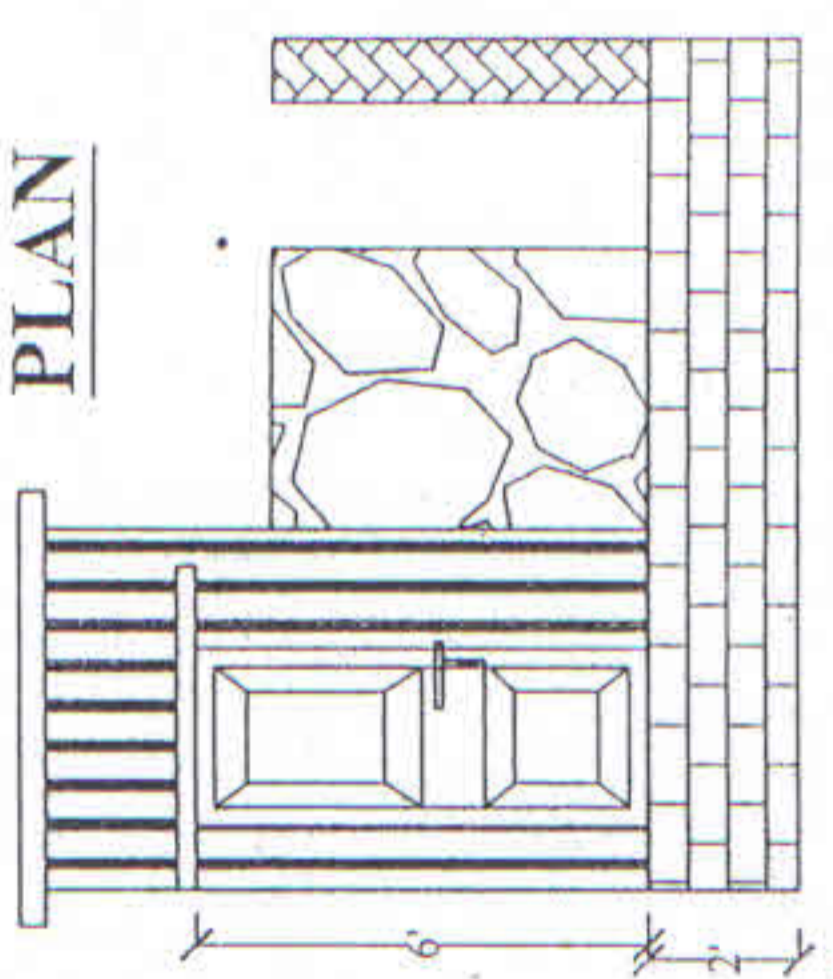

PROPOSED PLAN OF SEPTIC TANK & TOILET **AT A.T.I CENTER, JHARKHAND**

18¹⁴ 009

**ABSTRACT OF COST FOR THE P.H.E & SANITARY WORK AT AGRICULTURE TECHNOLOGY
INFORMATION CENTER, JHARKHAND**

S.NO	PARTICULARS	QUANTITY	UNIT	RATE	UNIT	AMOUNT
1/12.2.1	S/F/F of vitreous white glazed earthen ware I.W.C of parry/hindustan of any other I.S.S approved make 100mm H.C.I Trap 15Liters C.I pull and let go flushing system of names or other I.S.S equivalent make complete with all fittings C.I or C.C bracket 32 mm alkathene/PVC telescopic flush pipe about 2m long with one brass coupling and clamps G.I chain and pull including supplying and fixing a pair of vitreous white glazed earthenware footrest to be fixed in floor 15mm C.I body brass spindle stop cock of weight not less than 50gms 15mm PVC connecting pipe 450mm long exposed pipe and cisten with two coat of approved paint over acoat of primer etc. all comple as per specification and direction of E/I.	1	nos	2779.52	each	2779.52
2/12.2.5	S/F/F of vitreous white glazed earthen ware wash basin of parry/hindustan of any other I.S.S approved make supported on pointed C.I or R.S bracket 32mm C.I brass waste 15mm dia C.I body brass spindle stop cock of approved quality of weight not less than 350gms 32mm PVC waste pipe 750mm long with brass coupling at one end and making plumber joints etc. all comple as per specification and direction of E/I.	1	nos	1105.56	each	1105.56
3/12.2.3	S/F/F flat back or Angular lipped front vitreous white glazed earthen ware urinal of hindustan or parry or any other approved I.S.S make with 5 liter capacity C.I automatic flushing cisten of reliance for any other I.S.S approved make with all fittings with C.I or bracket standard size G.I flush pipe with fitting clamps, 15mm C.I body brass spindle stop cock of weight not less than 400gms 15mm PVC /Alkthene pipe 450mm long with brass coupling at both ends and doing plumber joints including painting of exposed part with two coats of paints over primer coat of red oxide cutting wall and floor, making good the same etc.all comple as per specification and direction of E/I.	5	nos	2207.18	each	11035.9
4/18.5.1 D.S.R	Providing and fixing C.P brass bib cock of approved quality confirm to IS-8931-15 mm dia normal bore approved brand CP fittings	3	nos	228.12	each	684.36
5/ 12.1.3 D.S.R	Supplying and fixing G.I pipe with red lead and yarn of following normal bore with screwed and socketed joints on wall ceiling and floor including supplying and fitting of wall hooks or pipes clamps wooden plug cutting pipe of size and threading ends if required etc. all comple as per specification and direction of E/I.					
	(a) 15mm nominal bore	10	m	81	m	810
	(b) 20mm nominal bore	25	m	88	m	2200
	(c) 25mm nominal bore	60	m	110	m	6600
6/12.122	S/F/F gun metetal following gate valve of approved quality all complete as per approved drawing and design building and PHED specification and direction of E/I.					
	(a) 20mm dia	3	nos	290.46	each	871.38
	(b) 25mm dia	1	nos	362.04	each	362.04

17-13-2008

7/12.1.13	Supplying and fixing of G.I fitting of approved make with all taxes all complete as per approved drawing and design building and PHED specification and direction of E/I.					
1. Elbow -	15mm	12	nos	26.06	each	312.72
	20mm	9	nos	35.02	each	315.18
	25mm	9	nos	51.4	each	462.6
2. Tee Plain-	15mm	6	nos	33.76	each	202.56
	20mm	6	nos	44.92	each	269.52
	25mm	6	nos	63.65	each	381.9
3. Reducing socket-	15mm	1	nos	24.5	each	24.5
	20mm	1	nos	30.62	each	30.62
	25mm	1	nos	42.3	each	42.3
4 Nipple-	15mm	9	nos	26.2	each	235.8
	20mm	6	nos	35.2	each	211.2
	25mm	2	nos	50.3	each	100.6
5 Union socket-	15mm	2	nos	48.4	each	96.8
	20mm	2	nos	63	each	126
	25mm	4	nos	84.75	each	339
8/12.40.2 D.S.R	Providing & fixing on wall face unplasticized rigid P.V.C rain water pipes confirming to IS-12592 Type A including jointing with seal ring confirming to IS:5382 leaving 10mm gap for					
	1) Single socketed pipes -110mm dia	10	m	194.45		1944.5
	2) SWR 110 mm dia single socket	8	m	198.45		1587.6
	3) SWR door Tee	1	nos	255		255
	4) SWR Plain Bend	6	nos	180		1080
	5) SWR water trap 65mm	2	nos	110		220
	6) SWR double socket 110mm dia	4	m	199.5		798
	7) SWR -Y 110mm	2	m	238		476
9/19.321 DSR	making soak pit 2.5m deep with 45x45cm dry brick honey comb shaft with bricks of class designation 75 and S.W drain pipe 100mm dia 1.8m long complete as per approved drawing and standard design building specification and direction of E/I.	1	nos	6000		6000
10 /MR	Supplying laying & fixing P.V.C water storage tank confirm to ISI including installation of tank with all complete as per approved drawing and standard design building specification and direction of E/I.	2	nos	5000		10000
Total Rs-						51961.2

Say Rs- 51,900/-

RS- 51,900/- (FIFTY ONE THOUSAND NINE HUNDRED) ONLY

Assistant Engineer

Soil Conservation, Ranchi

Dy. Director (Engg)

Directorate, Jharkhand

16/12/20

**ABSTRACT OF COST FOR THE ELECTRICAL WORK AT AGRICULTURE TECHNOLOGY
INFORMATION CENTER, JHARKHAND**

Sl No.	Particulars	Quantity	Unit	Rate	Unit	Amount
1/1.8EL D.S.R	Wiring for Light point/exhaust fan point/call bell point with 1.5sq mmm F.R.P.V.C insulated copper conductor cable in surface/recessed P.V.C conduit as required with with piano type swith, phenolic, laminated sheet M.S box earthing the point PVC insulated copper with 1.5sq mm with taxes all complete as per approved design, drawing, building & electrical specification and direction of E/I.	28	nos	472.43	each	13228.04
2/1.23 EL D.S.R	Supplying and fixing following piano type switch/socket on the existing M.S Box earthing the point PVC insulated copper with 1.5sq mm with taxes all complete as per approved design, drawing, building & electrical specification and direction of E/I.					
	(1) 5 Pin- 5/6 Amp socket	10	nos	28.00	each	280.00
	(2) 5 Pin -15 Amp socket	16	nos	70.00	each	1120.00
	(3) 15Amp Switch	16	nos	70.00	each	1120.00
3/1.12EL D.S.R	Wiring for Light point/Power plug wiring with 2x4 sq mm F.R.P.V.C insulated copper conductor single core cable in surface/recessed P.V.C conduit along with 1 no 4sq mm F.R.P.V.C insulated copper for loop earthing etc. as required with taxes all complete as per approved design, drawing, building & electrical specification and direction of E/I.	80	M	115.43	M	9234.40
4/MR	Earthing with G.I pipe 4.5mt long 40mm dia including accessories and providing masonry enclosure with cover plate having locking arrangment and watering pipe etc. with charcol and saltetc as required with taxes all complete as per approved design, drawing, building & electrical specification and direction of E/I.	1	nos	14000.00	each	14000.00
5	Design, farication & Assembling of LT Panel board					
B	300Amps F/P BUSBAR	1	No	2025.00	each	2025.00
E	40Amps TPN MCB	1	No	1080.00	each	1080.00
F	16Amps DP MCB	2	No	500.00	each	1000.00
G	25 Amps DP MCB	5	No	550.00	each	2750.00
H	10 Amps DP MCB	1	No	600.00	each	600.00
I	32 Amps DP MCB	5	No	250.00	each	1250.00
J	32 Amps TPN MCB	1	No	900.00	each	900.00
K	Volt Amp Meter, S. Switch, LT Switch, Indicator	1	No	3500.00	each	3500.00
6/MR	Panel wiring & Accessories :- copper wire, lugs, heat Shirkable tape, winder knob, insulator, binding strap & harware	1	set	2500.00	each	2500.00
7/MR	L.T Control electrical distribution panel is made of 16 SWG CRCA steel sheet. It is floor operated, Virmin proof, IP 54 protection an adequate size duly painted with red oxide primer & two coats of enamelaints with all complete locking arrangement	1	set	3000.00	each	3000.00
8/MR	Supplying and fixing electrical Armourd cable 25mmx4 core wiring from main switch with all complete job as per E/I.	40	M	202.00	M	8080.00
TOTAL-						65667.44

Say Rs- 65,600/-

RS- 65,600/- (SIXTY FIVE THOUSAND SIX HUNDRED) ONLY

15/12/20
Assistant Engineer
Soil Conservation, Ranchi

15/12/20
Dy. Director (Engg)
Directorate, Jharkhand

15 ✓

**ABSTRACT OF COST & DETAIL ESTIMATE FOR THE CONSTRUCTION OF A DEEP BORING
AT AGRICULTURE TECHNOLOGY INFORMATION CENTER**

CONSTRUCTION OF 200X150MM DIA HIGH YIELDING DEEP TUBE WELL					
SL. NO	ITEM OF WORKS	QUANTITY	UNIT	RATE	AMOUNT
1	Supplying of materials labour and tools & equipment for drilling 200 x 150mm dia deep bore well in any kind of soil and rock by using D/T/H super rig machine and ball hammer technology inclusive of mobilization demobilization of rig, air compressor all accessories tools and plant labour etc all complete job as per E/I.				
	(a) From 0 mtr to 30 mtr below the ground	30.00	mtr	450	13500.00
	(b) From 30mtr to 60 mtr below the ground	30.00	mtr	500	15000.00
	(c) From 60mtr to 90 mtr below the ground	30.00	mtr	550	16500.00
	(d) From 90mtr to 121.95 mtr below the ground	31.95	mtr	600	19170.00
2	Supplying all materials labour and lowering G.I. casing pipe 150mm internal dia for protecting the bore hole in over burden up to hard surface depth including all expenditure and grouting casing pipe etc. all complete job as per E/I.	30.00	mtr	675	20250.00
3	Cleaning flushing and developing of drilled hole for testing the discharge of water development of bore well by continuous flow of water by using heavy compressor up to satisfaction of E/I. to get uninterrupted flow of water free from sand and soil etc.				
	(a) 4hrs operation	1.00	P/H	700	700.00
4	Supplying and fitting M.S cap over 150mm dia casing pipe as per direction of E/I.	1.00	nos	890	890.00
5	Installation of pump, fitting & electrification.				
	(a) 1 no. submersible pump (1.5H.P)	1.00	nos	19500	19500.00
	(b) pannelled board	1.00	nos	2500	2500.00
	(c) 2.5 mm ² submersible cable	120.00	mtr	45	5400.00
	(d) 38mm Dia pvc submersible pipe	90.00	mtr	145	13050.00
	(e) rope 8 no.	90.00	mtr	15	1350.00
	(f) labour cost for lowering and plumbing work and electrification work	1.00	nos	3500	3500.00
	(g) Accessories of 38mm dia pipe	1.00	nos	2500	2500.00
Total Rs-					133810.00

Say Rs- 1, 33,800/-

RS- 1, 33,800/- (ONE LAKHS FIFTY THIRTY THREE THOUSAND EIGHT HUNDRED) ONLY

[Signature]
Assistant Engineer

Soil Conservation, Ranchi

[Signature]
Dy. Director (Engg)

Directorate, Jharkhand